

. EST 1956 .

# CARASEL

## TOWBARS

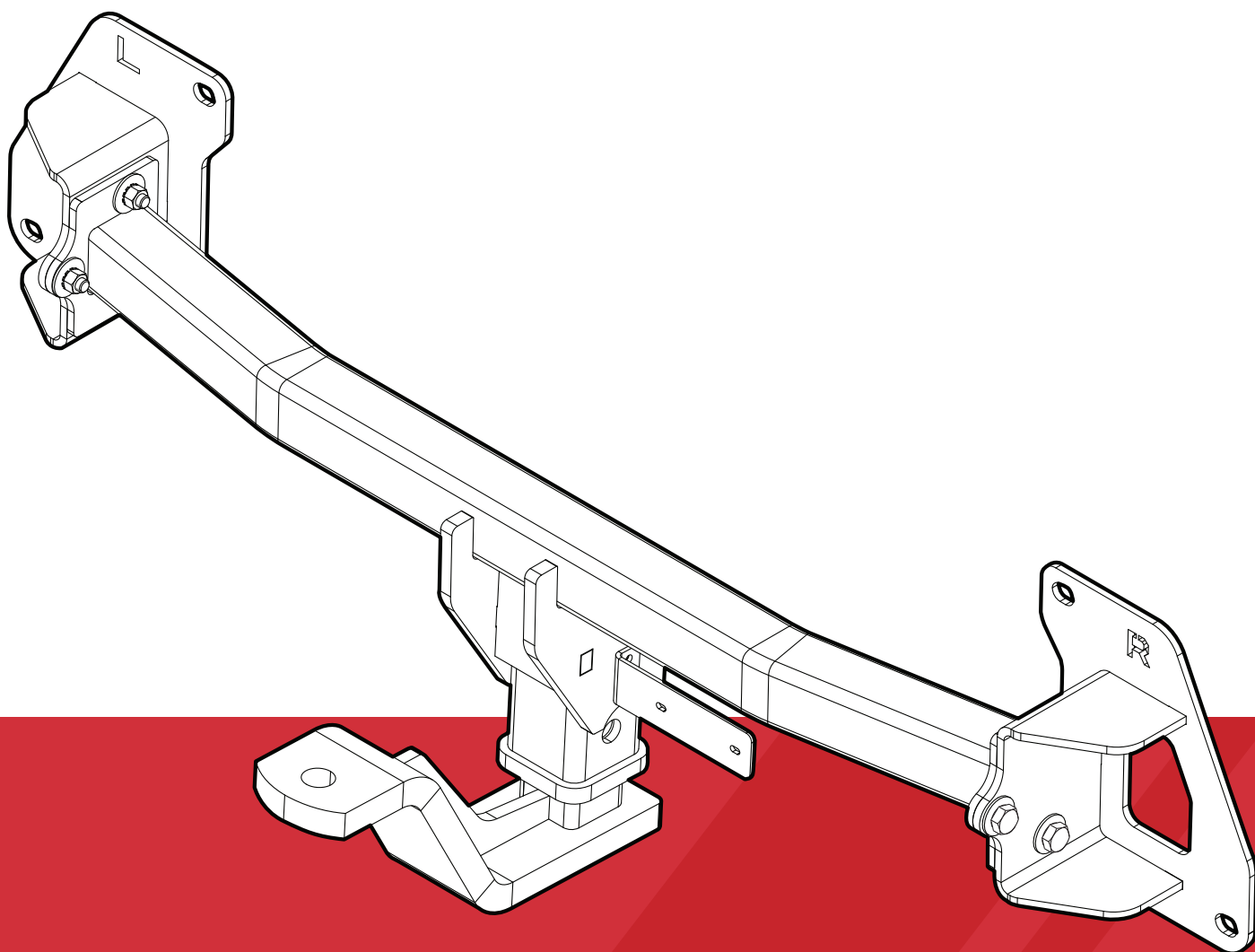

TESLA - MODEL 3  
P/N - TE2G2



LIFETIME  
WARRANTY

Issue02

### PARTS LIST

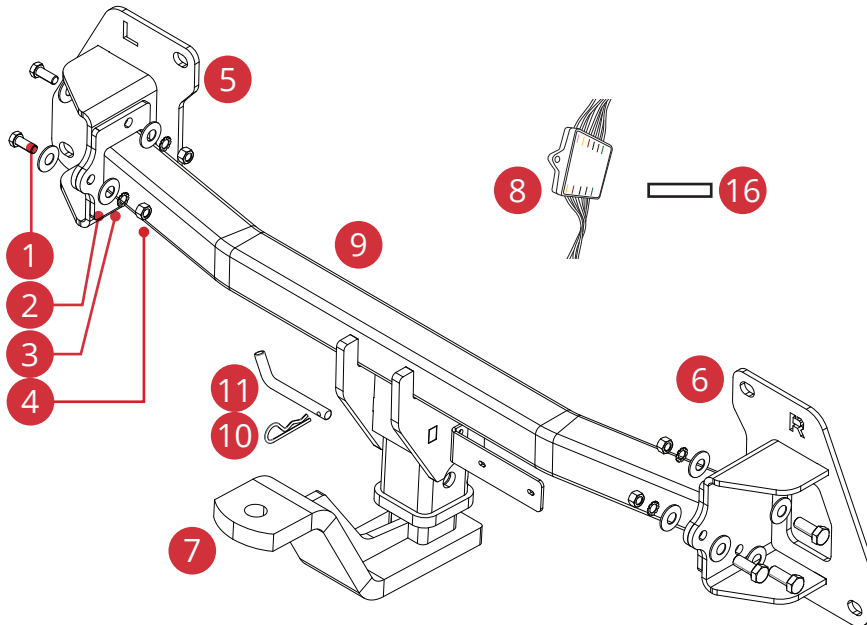

| PN | DESCRIPTION                  |     |
|----|------------------------------|-----|
| 1  | M12X35mm HEX SCREW           | x6  |
| 2  | M12 FLAT WASHER              | x12 |
| 3  | M12 TOOTHED WASHER           | x6  |
| 4  | M12 HEX NUT                  | x6  |
| 5  | VERTICAL BRACKET LEFT        | x1  |
| 6  | VERTICAL BRACKET RIGHT       | x1  |
| 7  | TOWBAR HITCH                 | x1  |
| 8  | TOWBAR BYPASS KIT            | x1  |
| 9  | CENTRE FRAMEWORK             | x1  |
| 10 | PIN                          | x1  |
| 11 | R-CLIP                       | x1  |
| 12 | SHIN PROTECTOR               | x1  |
| 13 | HITCH COVER                  | x1  |
| 14 | TOWBALL 50MM CHROME          | x1  |
| 15 | PLASTIC CHROME TOWBALL COVER | x1  |
| 16 | LOAD RATING LABEL            | x1  |

Tools required -  
 Trim removal tool. Philips-head.  
 Pliers.  
 10mm socket wrench.  
 Multitool.

### IMPORTANT INFORMATION

This product is for towing purposes only and must only be loaded as shown in your vehicle Owner's Manual.

- This towbar is NOT to be drilled, cut, welded, or modified in any way.
- Check behind chassis rail and body panels before drilling to ensure no hazards are present
- All load ratings shown are under the assumption your trailer has a functional braking system installed
- When installed in positions other than the one depicted in these instructions the Tow Ball Mount may interfere or obstruct certain features of your vehicle (tailgate opening, Chassis clearance, etc.)

#### General:

- Before fitting this towbar read fitting instructions and check installation hardware is correct.
- Check that the towbar is suitable for the vehicle and be wary of any changes to the vehicle design that may conflict with the fitting of this towbar. (Tray, Canopy, Suspension etc.)
- After drilling, blow any filings clear, remove any swarf and treat exposed metal with a rust inhibitor.

#### Towbar Maintenance and Care:

- It is recommended, when not in use, the Tow Ball Mount assembly and CLASS 4 Pin and Clip is stored inside the car away from moisture to prevent standing water from forming rust.
- Inspect to ensure, on regular basis, fasteners are torqued to the specifications below and in good condition.
- Ensure that the fitting instructions are read and understood prior to fitment
- Place these instructions in the vehicle's glovebox after installation is completed

## STEP 1

Using trim tools, remove the three body-work plugs from the rear wheel-wells. Two plugs are located behind the wheel.

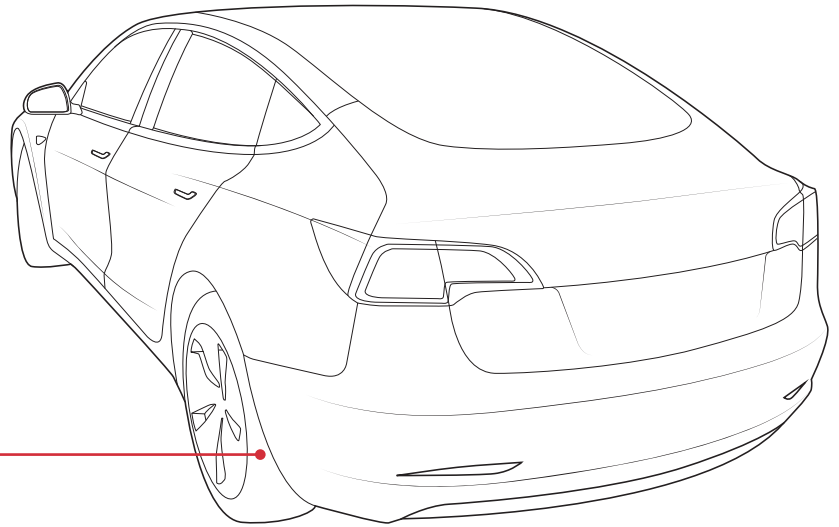
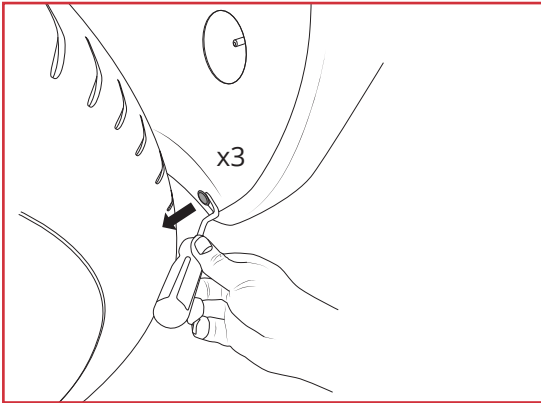

## STEP 2

On the underside of the rear bumper, behind the wheels, use a 10mm socket and remove the hardware shown.

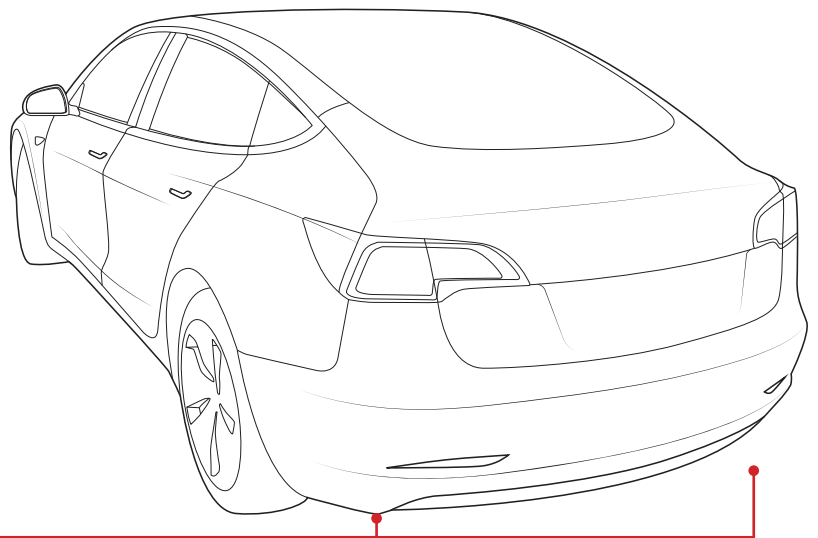
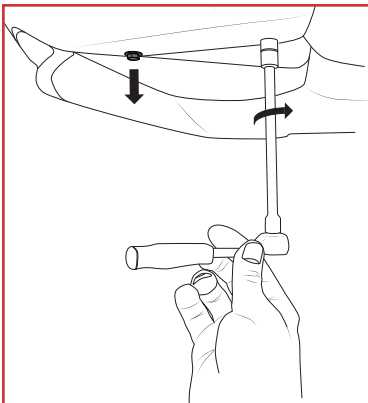

## STEP 3

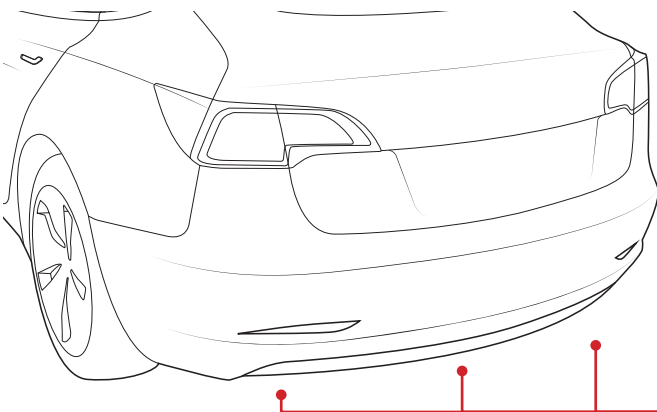

Undo the clips along the underside of the rear bumper.

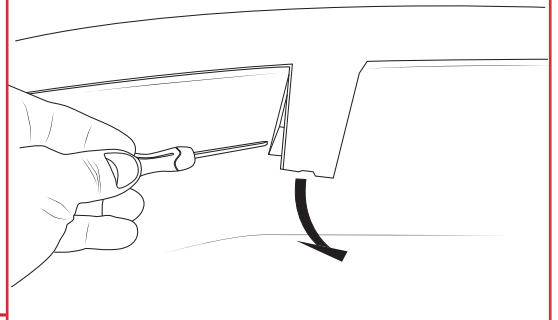

## STEP 4

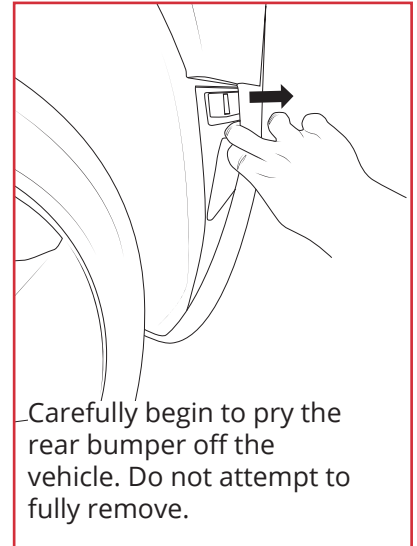
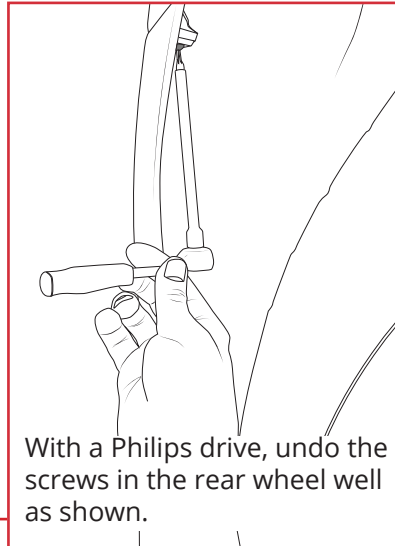
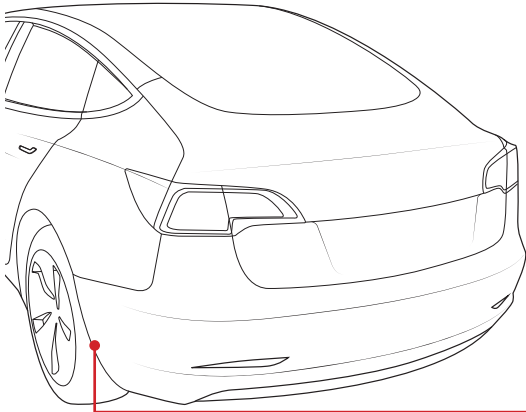

## STEP 5

Open the boot of the vehicle.

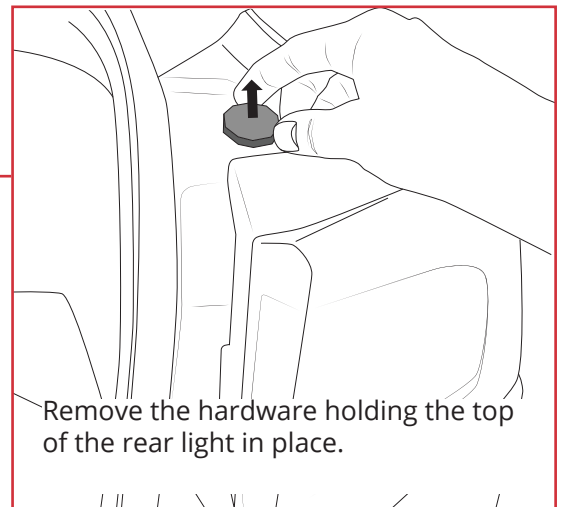
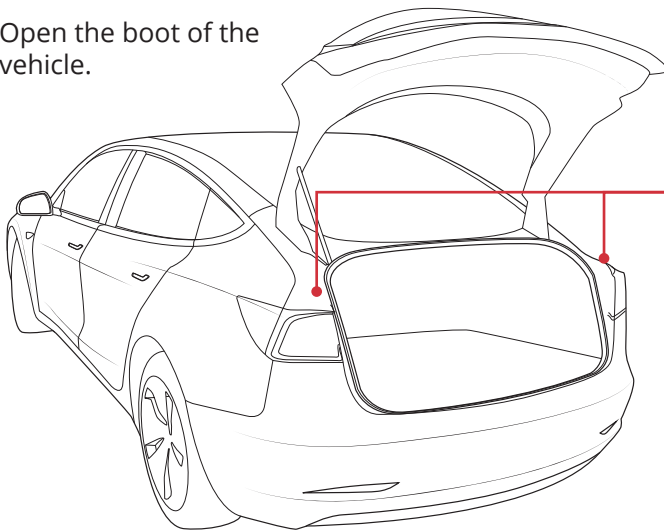

## STEP 6

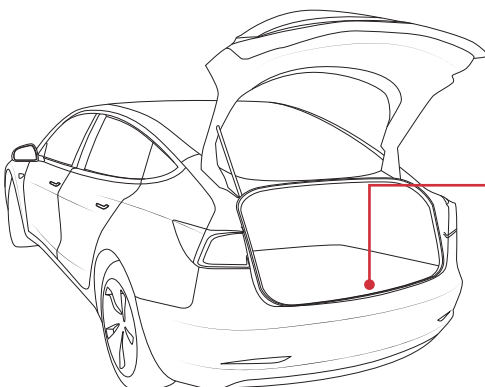

Unclip boot protective panel using a trim removal tool.

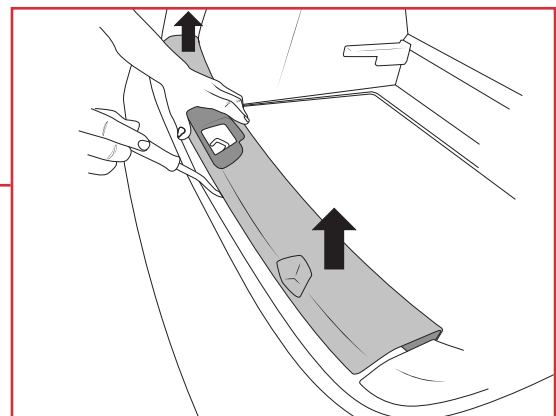

## STEP 7

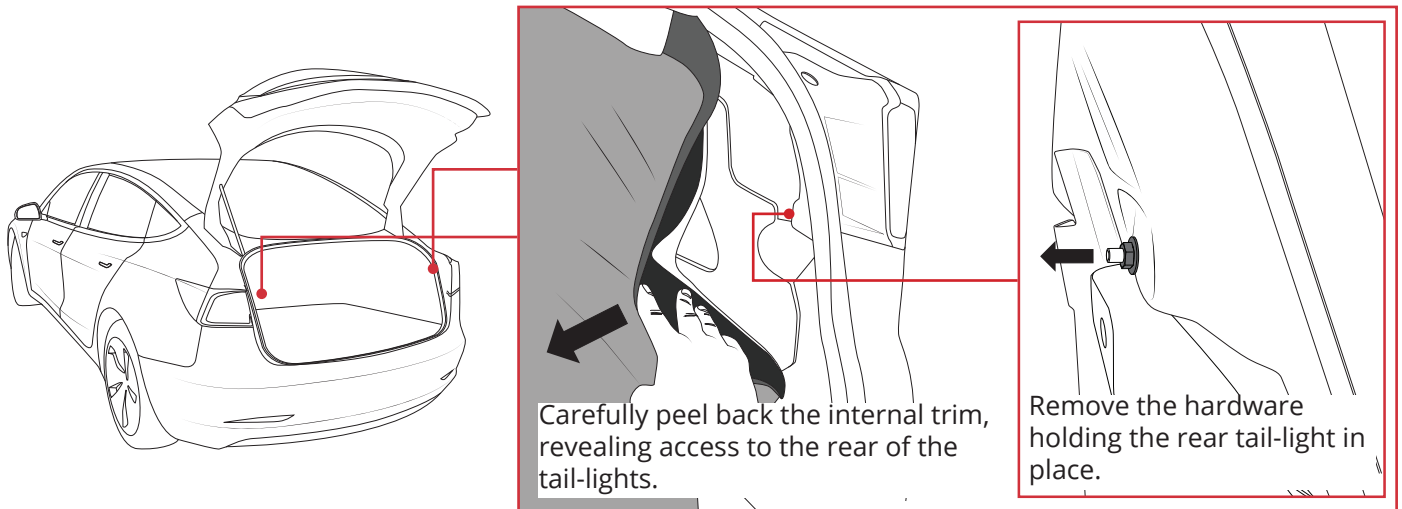

## STEP 8

Unhook the cabling to the rear lights.

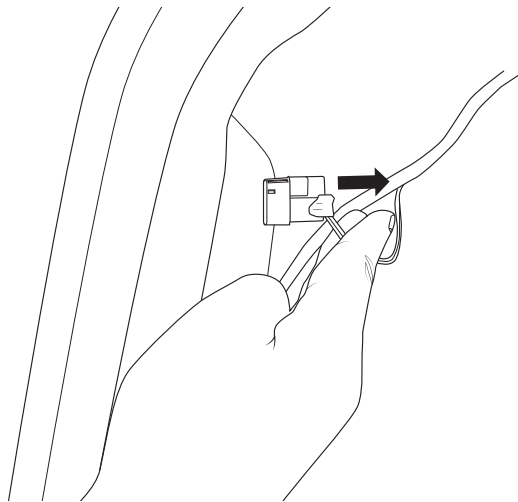

## STEP 9

Carefully lift out the rear tail-lights.

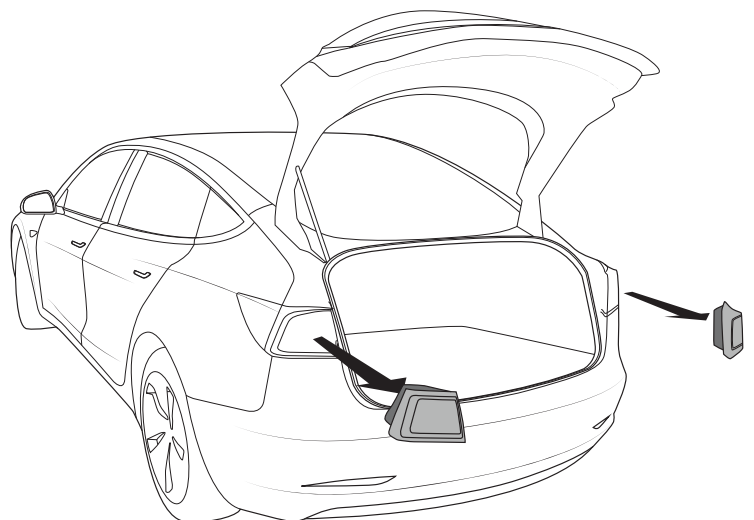

## STEP 10

Carefully remove the rear bumper.

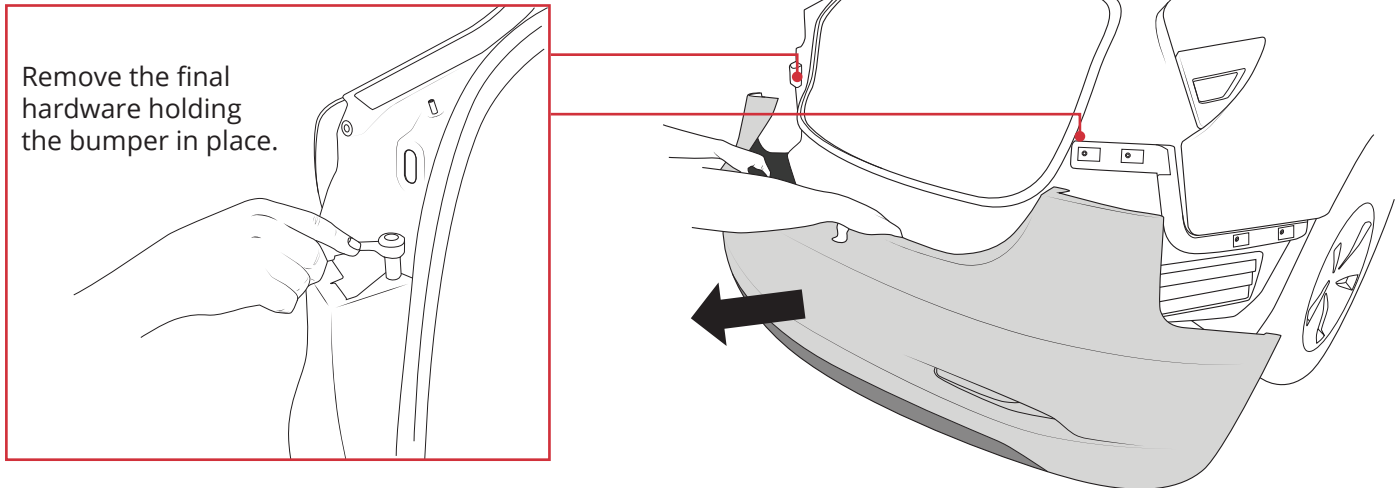

## STEP 11

Unclip and unbolt the harness via 4x 10mm bolts. Place to the side for refitting. Remove the sensor harness.

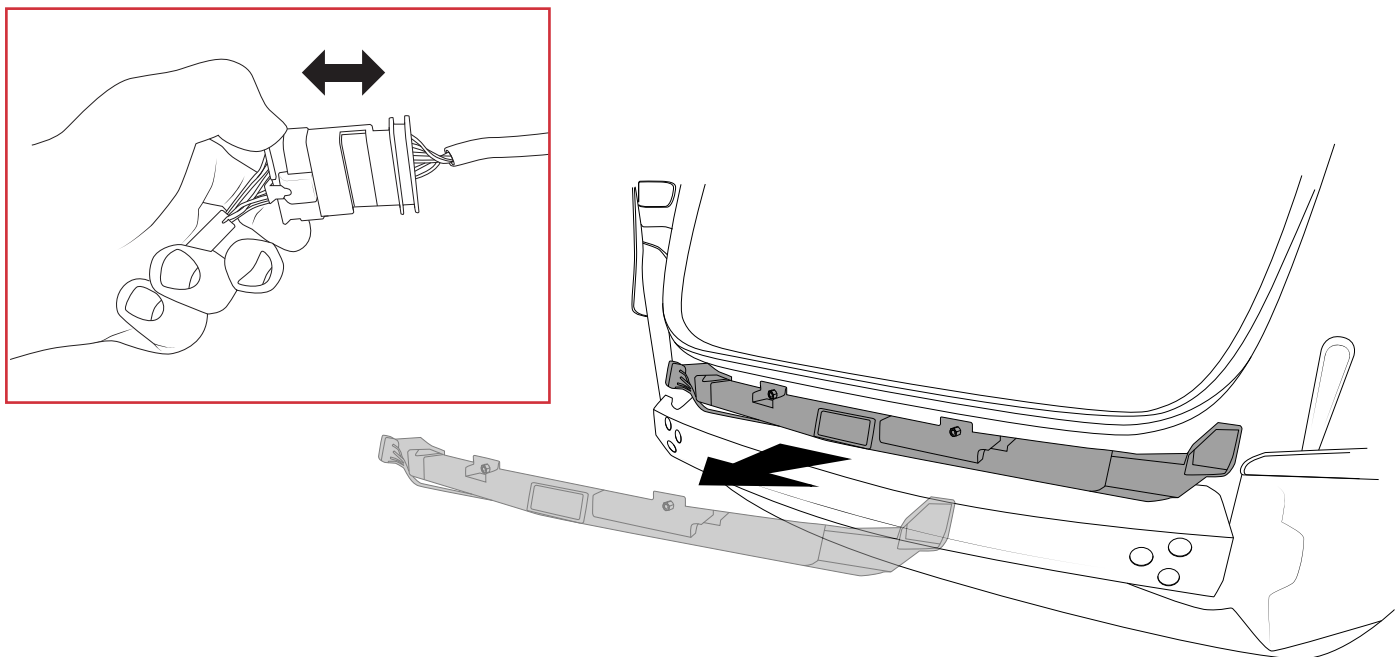

## STEP 12

Remove the alloy reinforcement bar and brackets. Undo the brackets, both top and bottom, at either end.

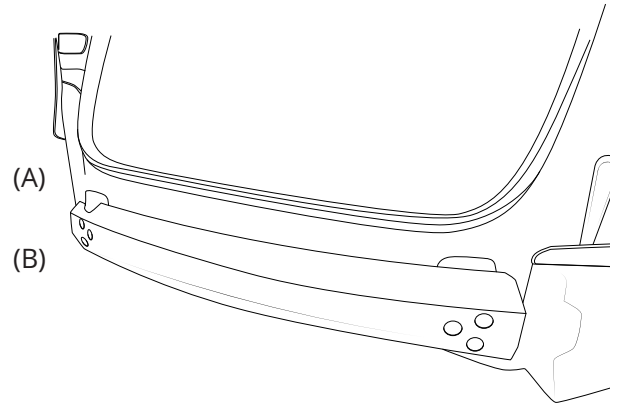
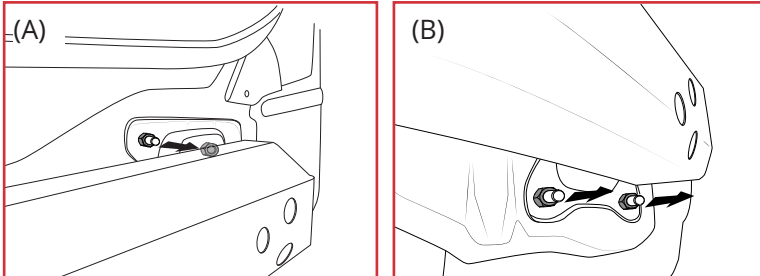

Then remove reinforcement from factory mounting brackets and discard the factory mount, and tow retaining bolt.

## STEP 13

Using the hardware removed in the previous step, fix the left and right vertical bracket in place.

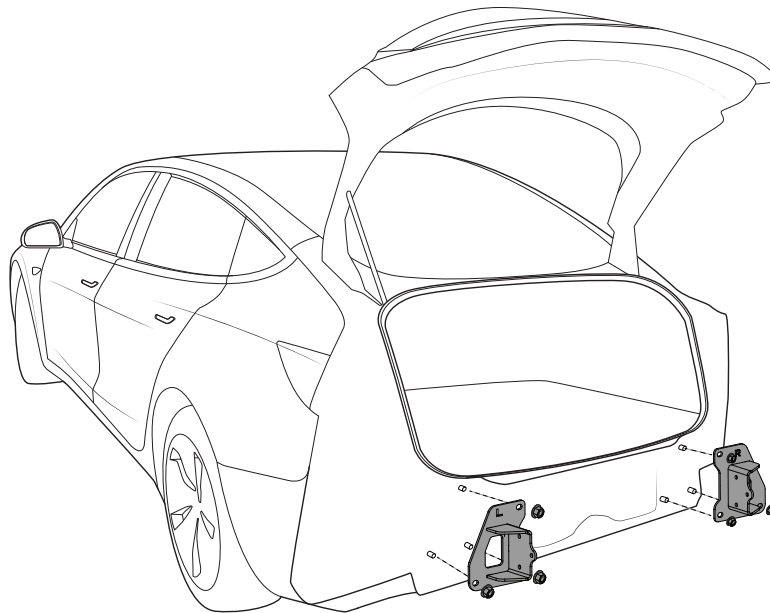

## STEP 14

Fix the centre framework into place with the M12 hardware provided.

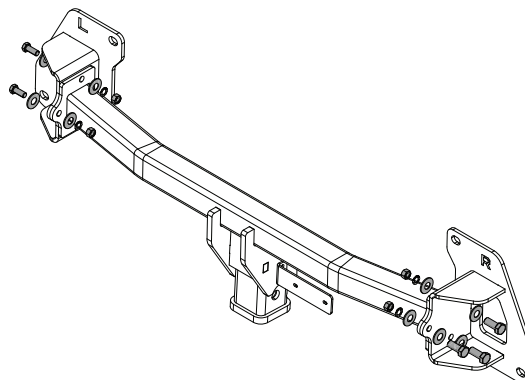

## STEP 15

Refit the sensor harness.

Re-clip the harness to the vehicle.

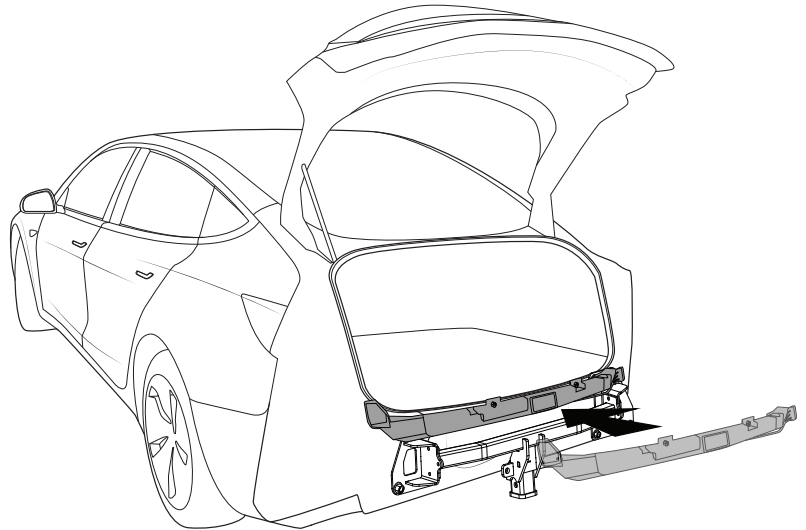
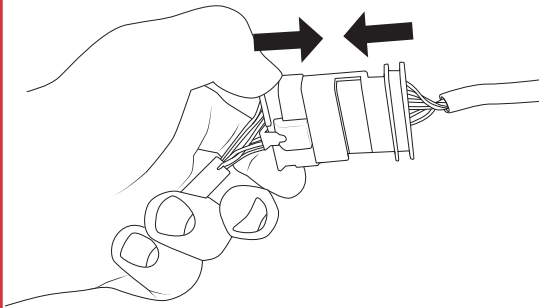

## STEP 16

Splice the wiring harness into the cabling removed from the tail-lights in step 8.

Grey - Brake  
Red - Left  
Yellow - Tail  
Black - Earth  
Brown - Right

NOTE: WIRE COLOURS MAY VARY ACROSS VEHICLES. ALWAYS TEST YOUR LIGHT CONNECTIONS.

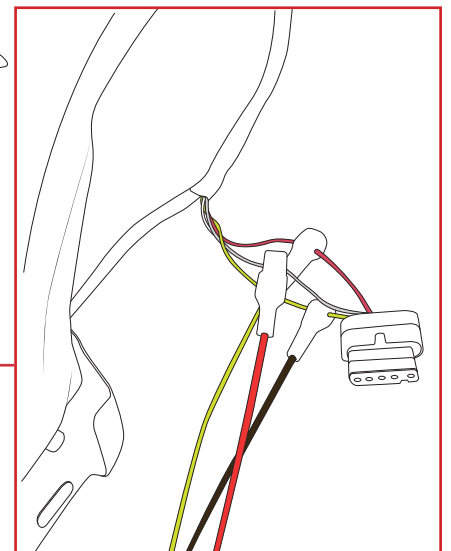
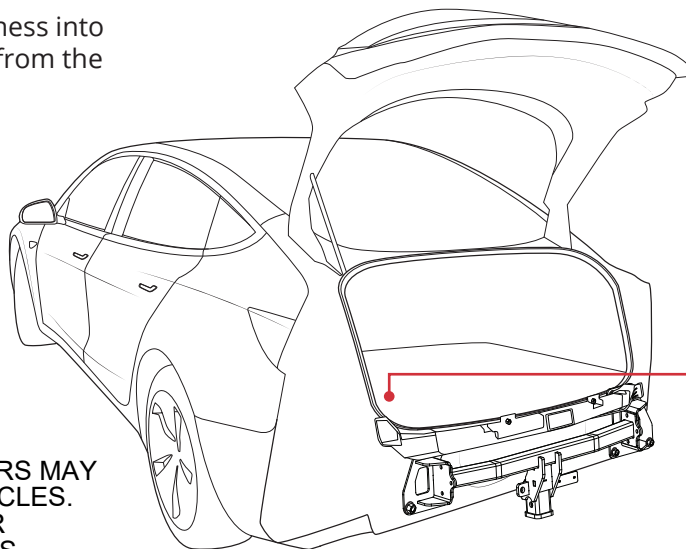

## STEP 17

Connect the earth, this is located just below the tail-light wiring.

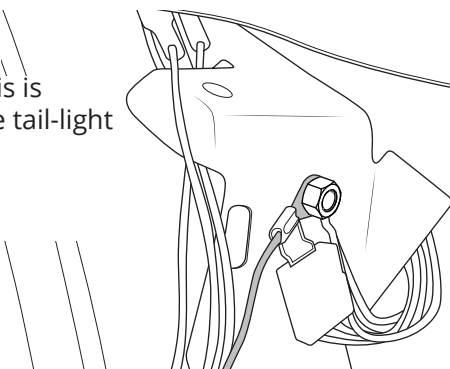

Connect the pink wire (wiring harness) into the red cable on the sensor harness.

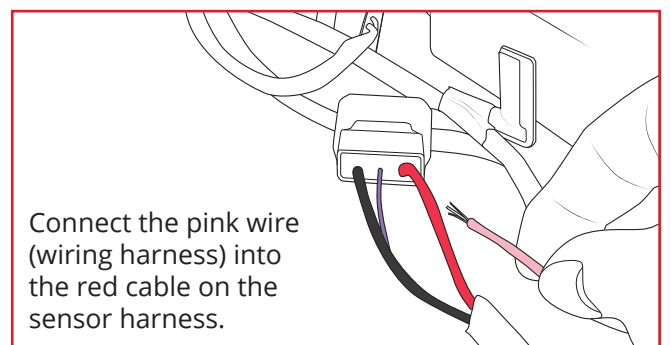



## STEP 18

Remove the backing tape from the wiring harness and fix it below the where the earth was connected in the previous step.

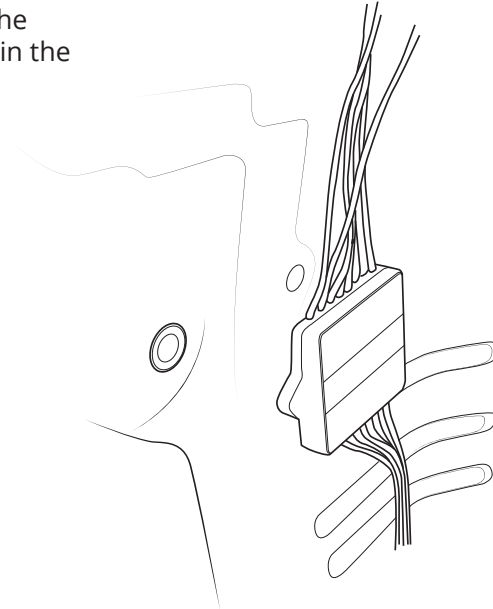
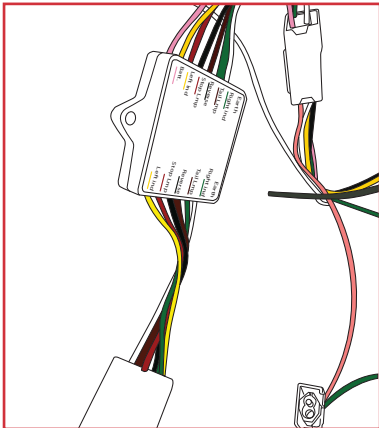

Note: Attach the 7 pin to the installed hitch assembly at this stage.

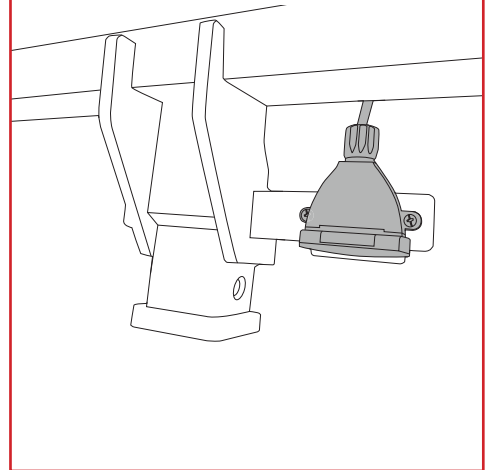

## STEP 19

Find the centre line of the inside of the bumper that was removed in step 10.

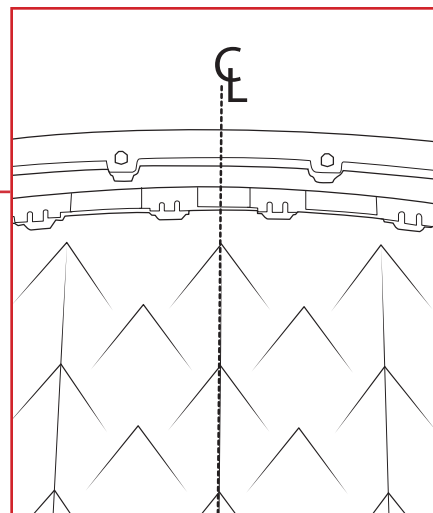
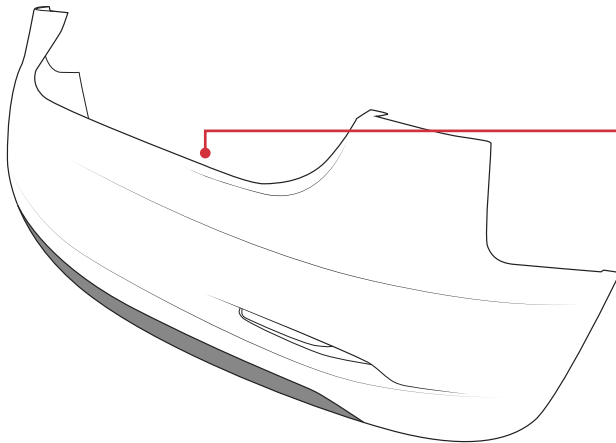

## STEP 20

With a marker, mark out the dimensions shown, starting at the centre line.

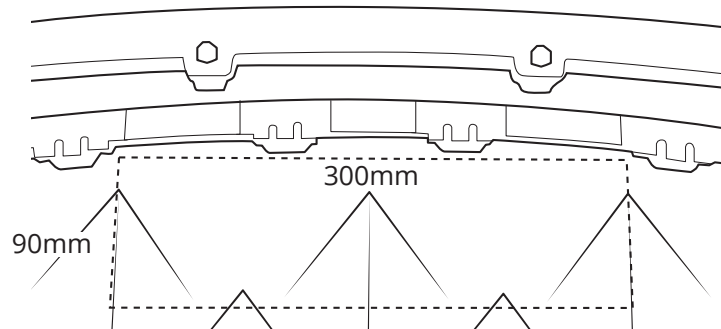

## STEP 21

Using a power drill, drill through each corner of the rectangle just drawn in the bumper.

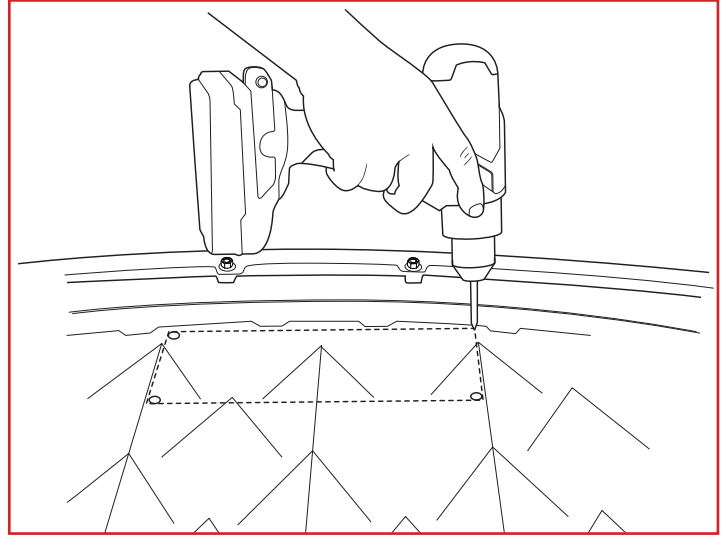

## STEP 22

Using a multi-tool, carefully cut between the holes drilled previous. This is done easiest from the opposite side.

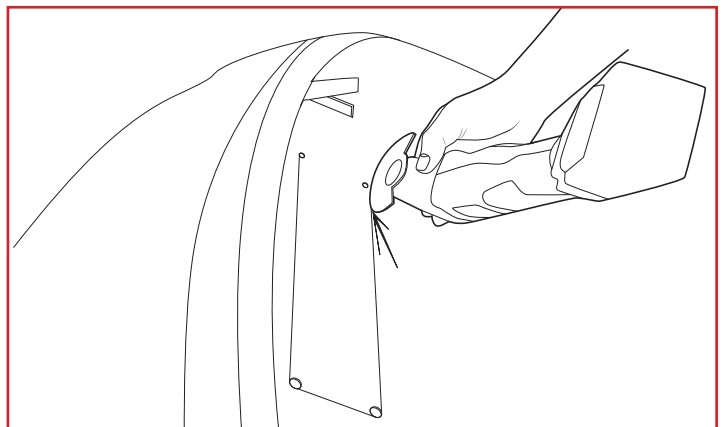

## STEP 23

Refit the rear bumper

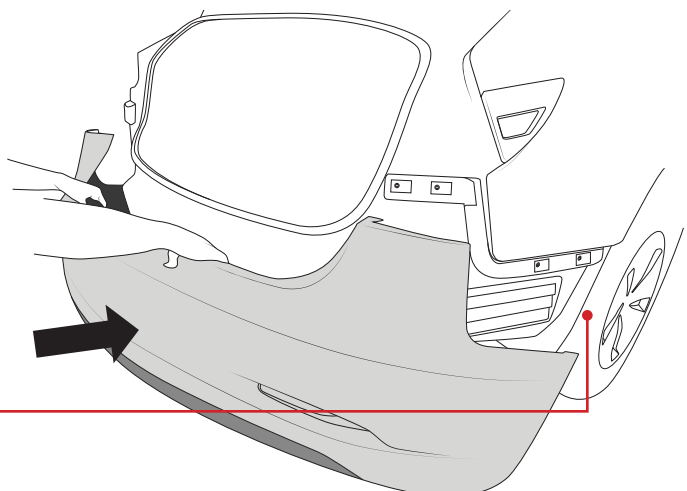
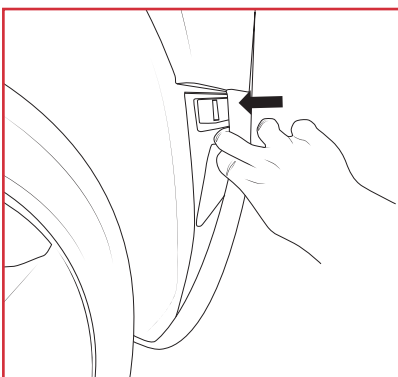

## STEP 24

Refit the tail-lights.

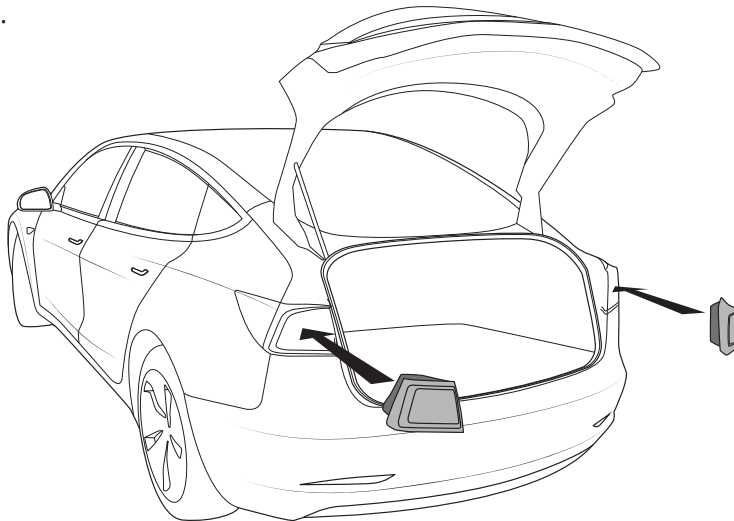

Reconnect the light cabling.

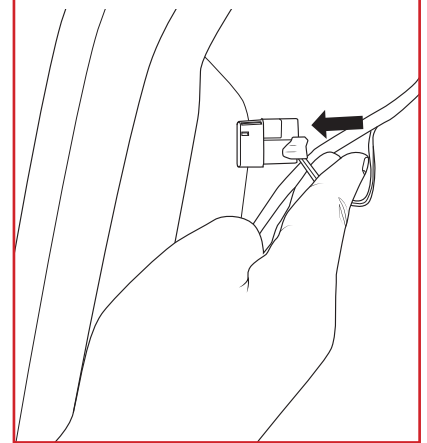

## STEP 25

Refit the hardware from the wheel well and tail lights.

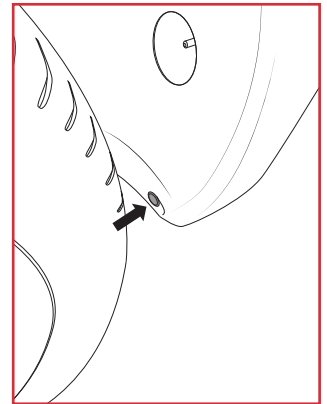
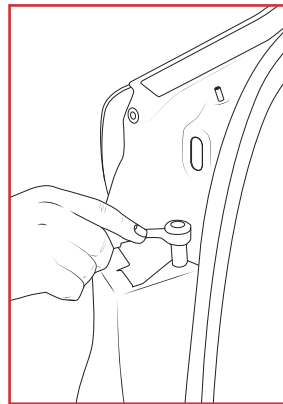
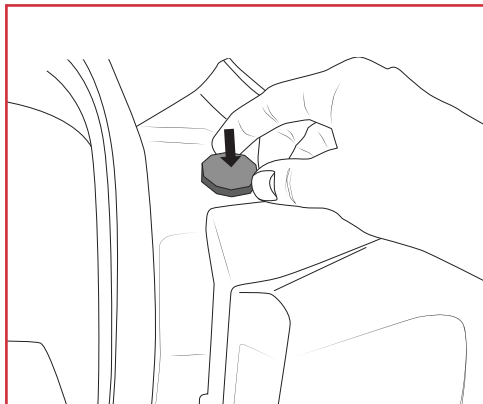
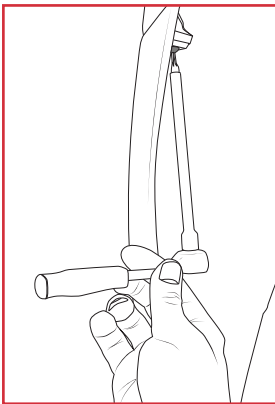

## STEP 26

Refit the protective panel within the boot rim.

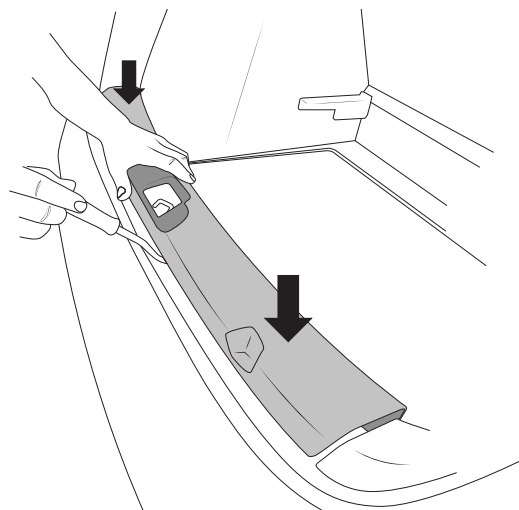

## STEP 27

- A) Slide the towbar hitch into place.
- B) Use the pin to hold the hitch in place.
- C) Using an R clip, fix the pin in place.
- D) Tighten anti rattle bolt to prevent noise.

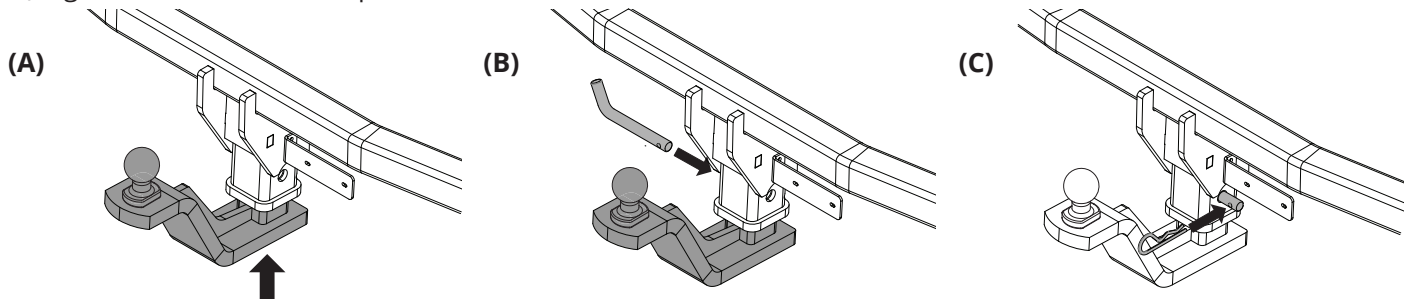

## STEP 27

Install the load rating sticker provided, inside the drivers door.

