



EST 1956
CARASEL®

**FITTING
INSTRUCTIONS**

TESLA — MODEL Y

P/N — TE1G2
CONTROLLED

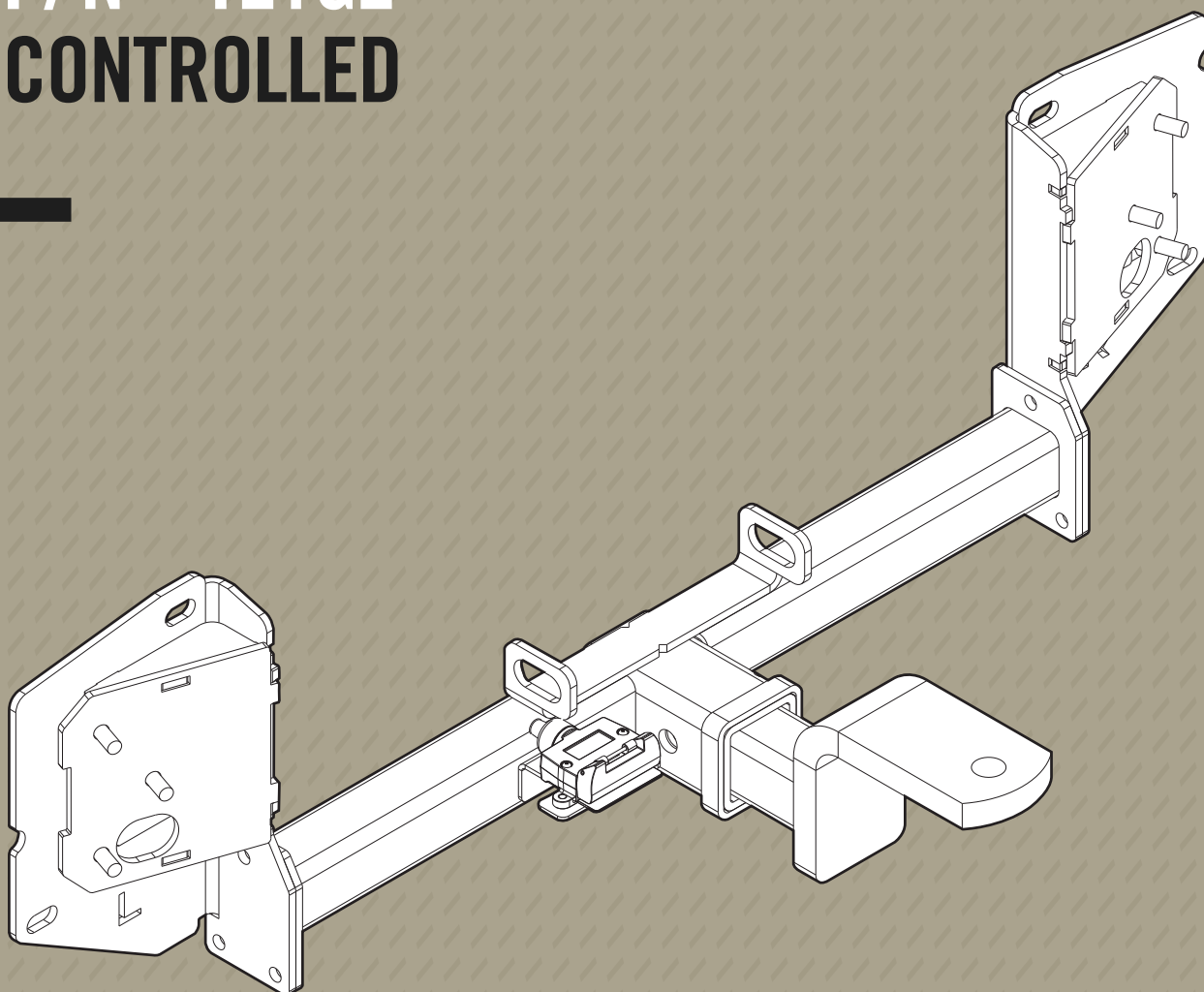

ISSUE #: 03
ISSUE DATE: 05/09/24

CONTENTS

| | |
|----|--------------------------------|
| 2 | IMPORTANT INFORMATION |
| 4 | PARTS LIST |
| 6 | VEHICLE PREPARATION |
| 8 | TOWBAR INSTALLATION |
| 11 | GENERAL WIRING STEPS |
| 12 | FITTING ADDITIONAL COMPONENTS |
| 13 | REVERSE LED LIGHTS |
| 14 | ANDERSON PLUG BRACKET |
| 15 | TRAILER REVERSE CAMERA BRACKET |
| 16 | AIRBAG BRACKET |
| 17 | FINALISE FITMENT |
| 18 | TOWBALL USAGE |

IMPORTANT INFORMATION

- CHECK THE MAXIMUM TOWING CAPACITY OF YOUR VEHICLE AS STATED BY THE VEHICLE MANUFACTURER.
- DO NOT EXCEED THE MAXIMUM TOWING CAPACITY OF YOUR VEHICLE OR OF THIS TOWBAR. COMPLY WITH THE LOWEST OF THESE TWO VALUES.
- THIS PRODUCT IS FOR TOWING PURPOSES ONLY AND MUST ONLY BE LOADED AS STATED IN YOUR VEHICLE OWNER'S MANUAL.

CHECK:

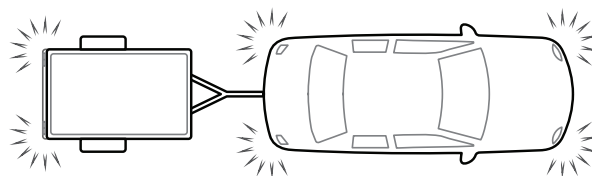

0km



Torque
hardware

+1000km



Re-torque
hardware

+1000km



Re-torque
hardware





+1000km



GENERAL:

- Read these instructions thoroughly and check all components are correct before installation.
- These instructions must be followed for warranty to be upheld.
- Check that the towbar is suitable for the vehicle and be wary of any aftermarket changes to the vehicle design that may conflict with the fitting of this towbar. (Tray, Canopy, Suspension etc.)
- Load ratings specified are under the assumption that your trailer has suitable braking systems for its weight.
- After installation is completed, store these instructions in the vehicle's glovebox with vehicle's manual.
- When towing a load behind your vehicle, the handling characteristics of your vehicle will be affected. Be cautious when cornering, braking and accelerating, especially when towing wind-resistant loads, and when travelling in off-road conditions.

WARNING:

- Always inspect towbar and towbar accessories before use.
- Do not use towbar if any signs of damage, rust corrosion or fractures are present.
- Do not alter or modify this towbar in any way.
- Do not install / use towbar if there is any damage near the towbar mounting area, or if your vehicle is involved in a collision.
- If vehicle drilling is required, check behind chassis rail and body panels before drilling to ensure no hazards are present. After drilling, remove swarf and treat exposed metal with a rust inhibitor.
- Ensure that your vehicle is on level ground and securely parked before beginning installation / maintenance work.
- Always wear appropriate protective gear before beginning installation / maintenance work.    

TOWBAR MAINTENANCE AND CARE:

- Regularly inspect all bolted connections, ensuring they are torqued to the specifications below and are in good condition.
- Clean tow ball and hitch with brake cleaner to avoid abrasion.
- When not in use, store the Tow Ball Mount assembly and CLASS 4 Pin and Clip inside the car away from moisture.
- Before driving with a trailer, attach the trailer to the towbar and check that all electrical wiring is fully functional.

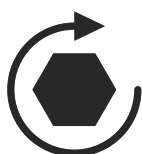

TIGHTEN BOLTED CONNECTIONS TO THE FOLLOWING TORQUE SETTINGS,
UNLESS OTHERWISE SPECIFIED IN INSTRUCTION STEPS:

M16: 210 - 240 Nm

M12: 100 - 120 Nm

M6: 12 - 15 Nm

M14: 150 - 170 Nm

M10: 60 - 70 Nm

M4: 4 - 5 Nm

These fitting instructions are the property of Carasel Pty. Ltd. and may not be altered for any other purpose than intended.

PARTS LIST

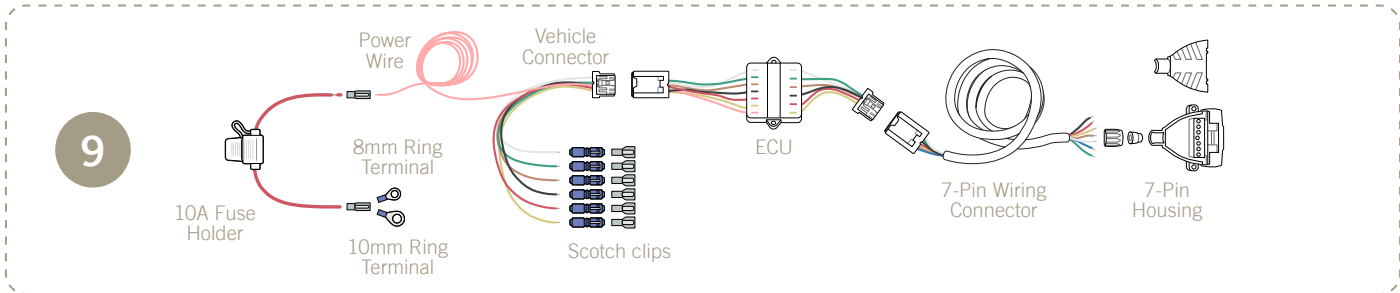
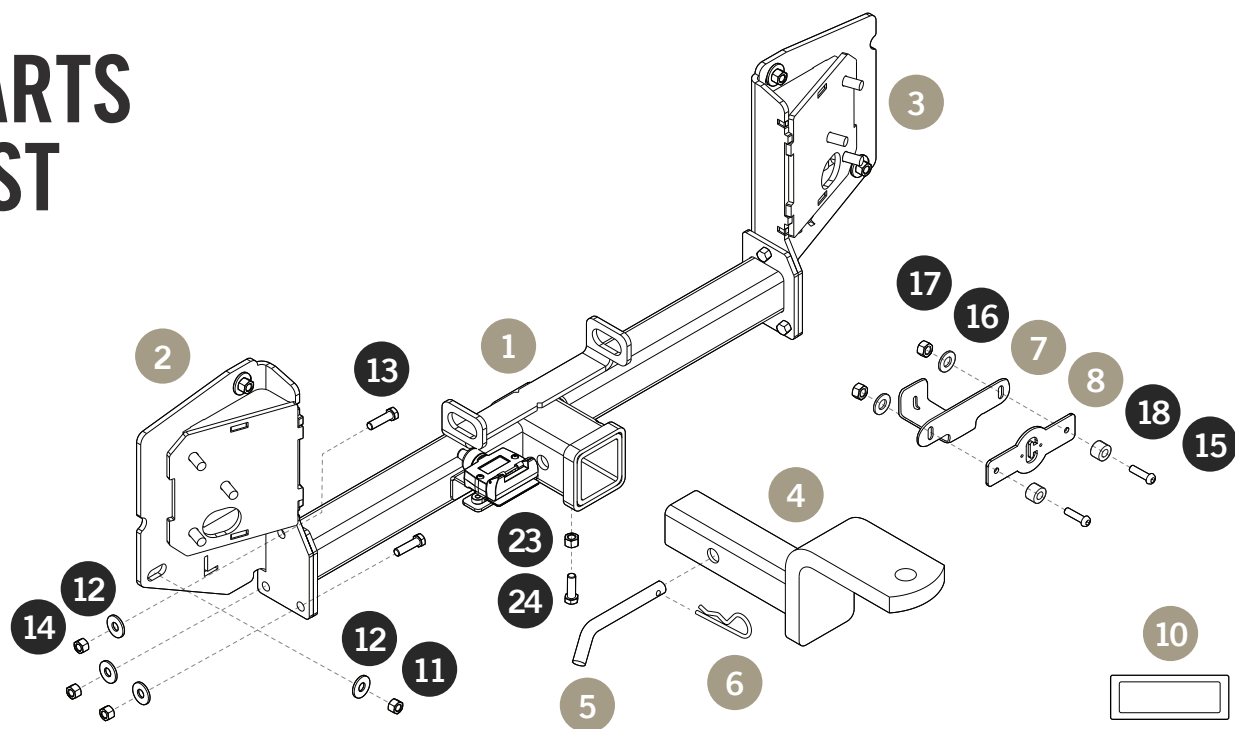

| # | PART | QTY |
|----|----------------------|-----|
| 1 | CROSS-BEAM | x1 |
| 2 | LEFT CORNER BRACKET | x1 |
| 3 | RIGHT CORNER BRACKET | x1 |
| 4 | TOWBAR HITCH | x1 |
| 5 | PIN | x1 |
| 6 | R-CLIP | x1 |
| 7 | CARASEL PLATE | x1 |
| 8 | BACKING PLATE | x1 |
| 9 | TOWBAR BYPASS KIT | x1 |
| 10 | LOAD RATING STICKER | x1 |

| # | HARDWARE | QTY |
|----|-------------------------|-----|
| 11 | M10 FLANGE 1.5p NUT | x6 |
| 12 | M10 FLAT WASHER | x12 |
| 13 | M10 x 30mm x 1.25p BOLT | x6 |
| 14 | M10 x 1.25p NUT | x6 |
| 15 | M6 x 35mm BOLT | x2 |
| 16 | M6 FLAT WASHER | x2 |
| 17 | M6 LOCKNUT | x2 |
| 18 | M6 NYLON SPACER TUBE | x2 |
| 19 | M4 BOLT | x2 |
| 20 | M4 WASHER | x2 |
| 21 | M4 NUT | x2 |
| 22 | 3/8" ANTI RATTLE BOLT | x1 |
| 23 | 3/8" NUT | x1 |

TOOLS REQUIRED

- 10.5mm Drill Bit
- Trim Removal Tool
- 17mm Socket Wrench
- 19mm Socket Wrench
- Torque Wrench
- Soldering Iron
- Electrical Tape

VEHICLE PREPARATION

STEP 01

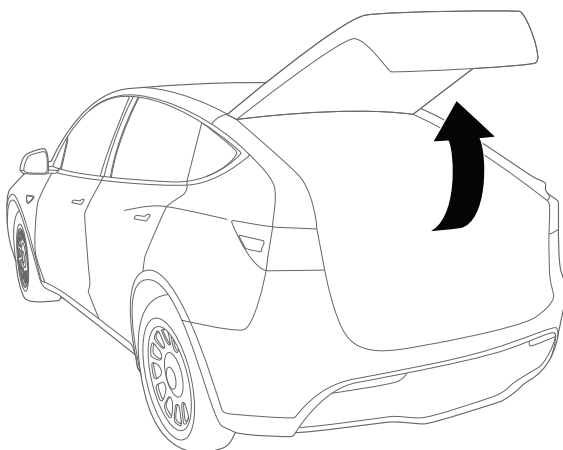

STEP 02

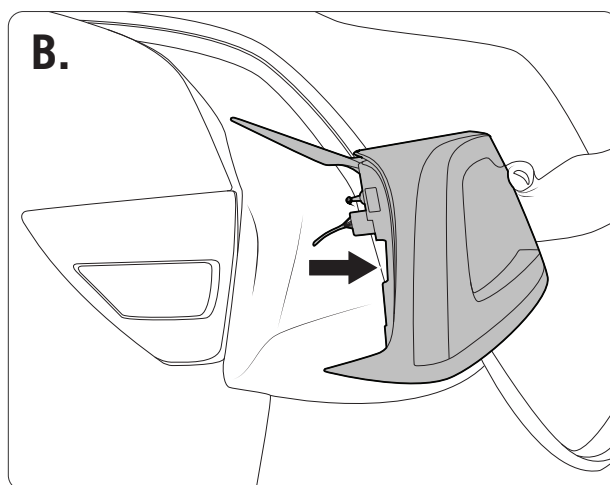
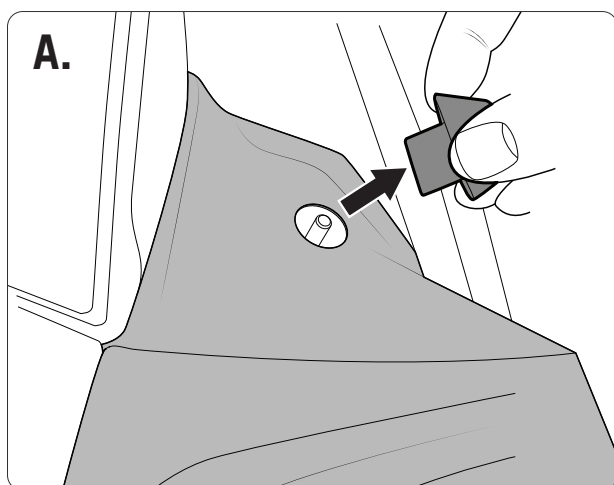
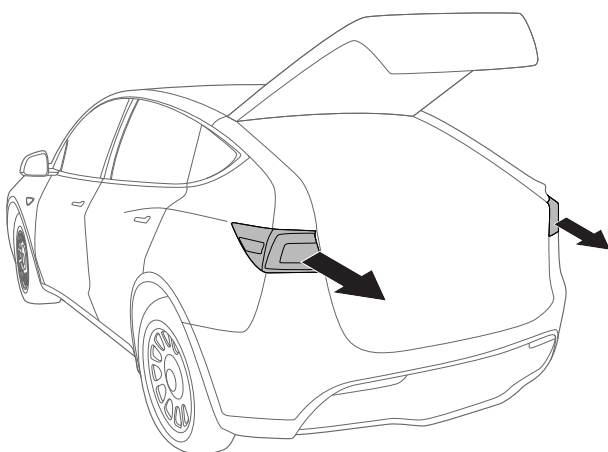

STEP 03

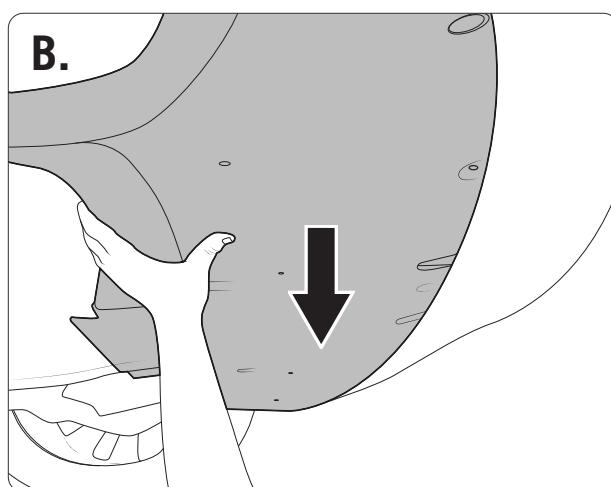
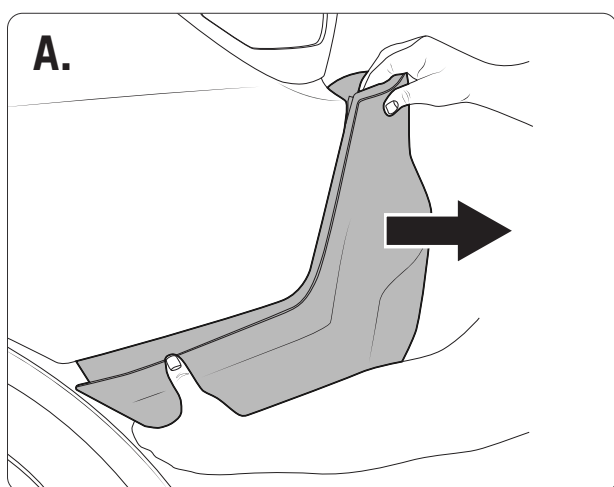
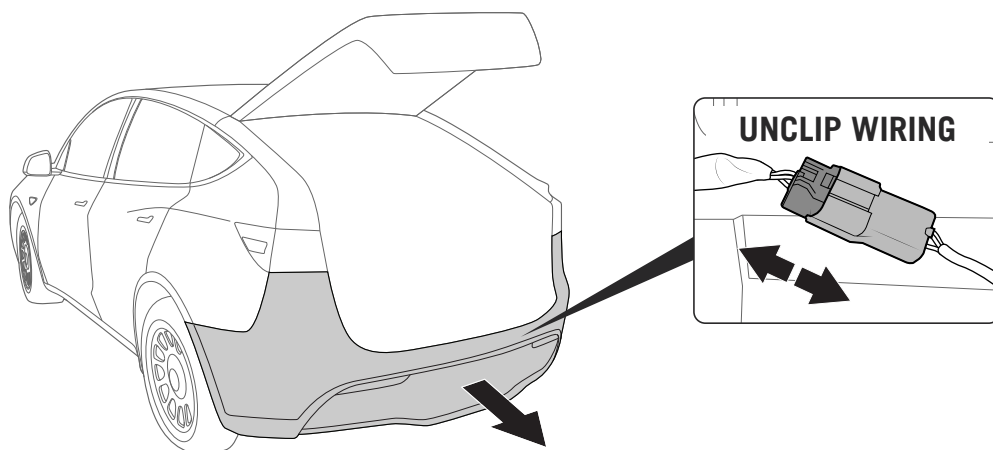

STEP 04

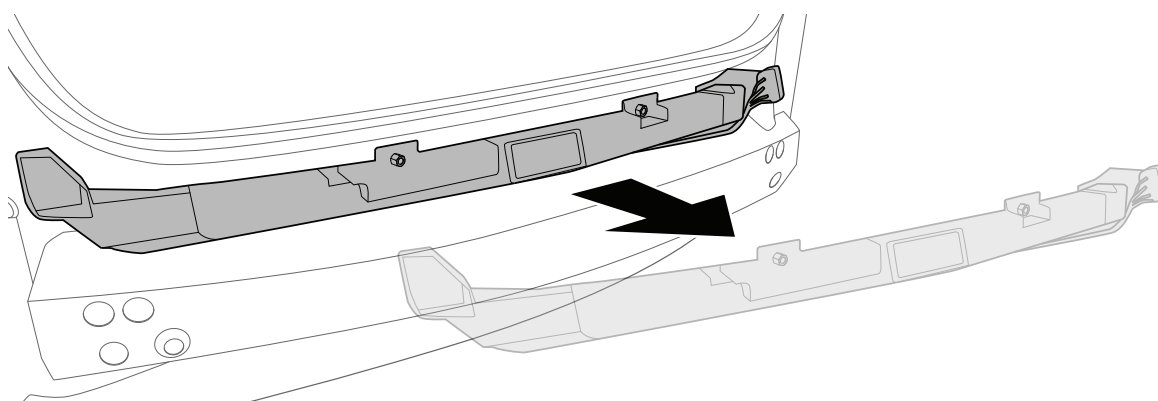

STEP 05

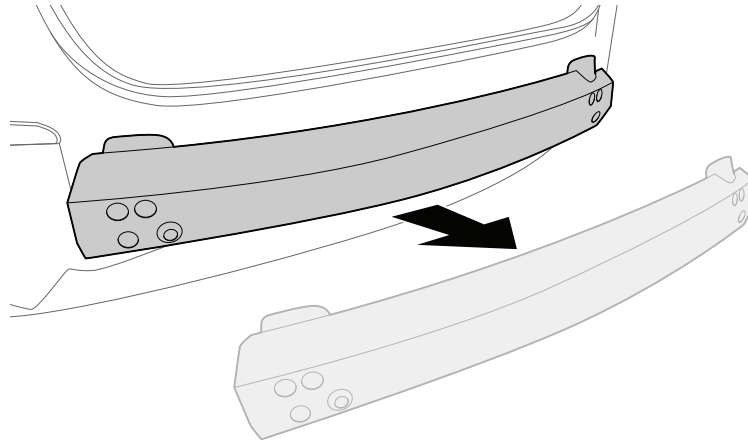

Keep hardware for **STEP 09**

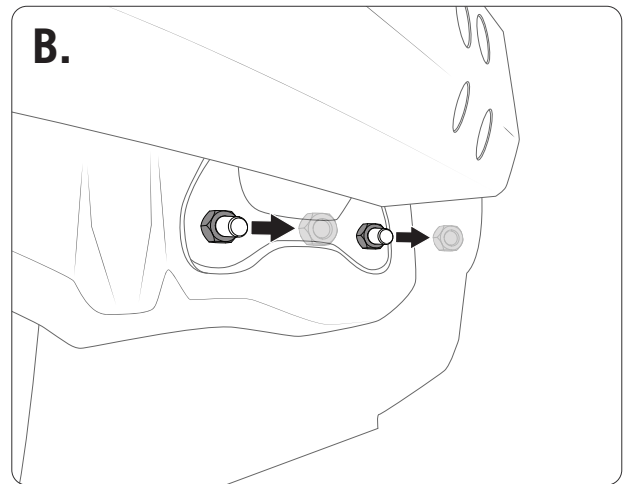
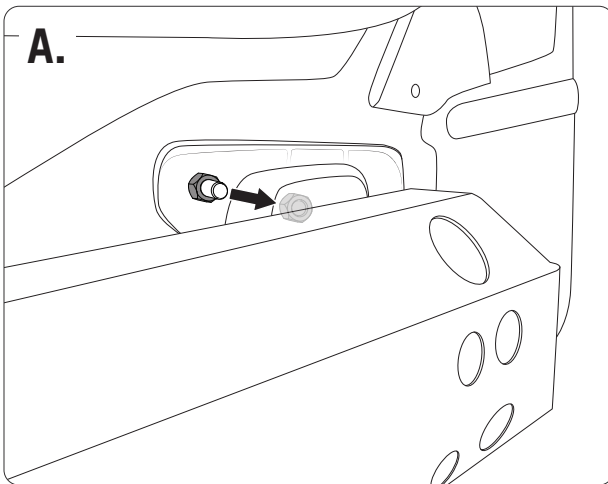

TOWBAR INSTALLATION

STEP 06

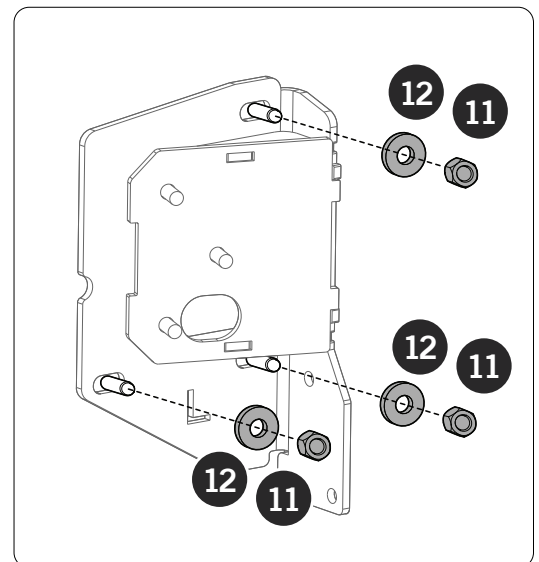
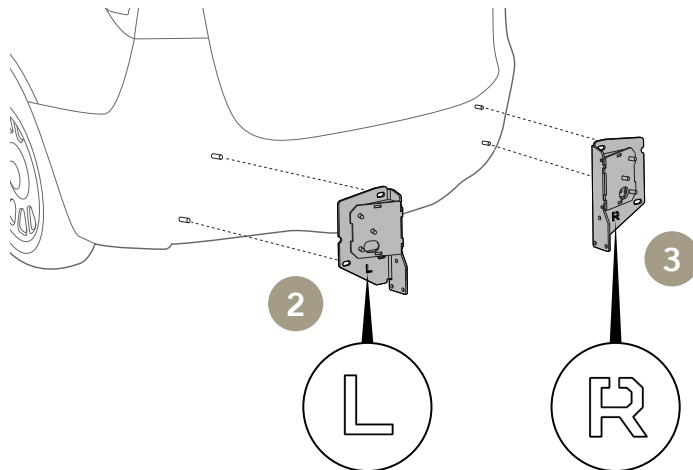

STEP 07

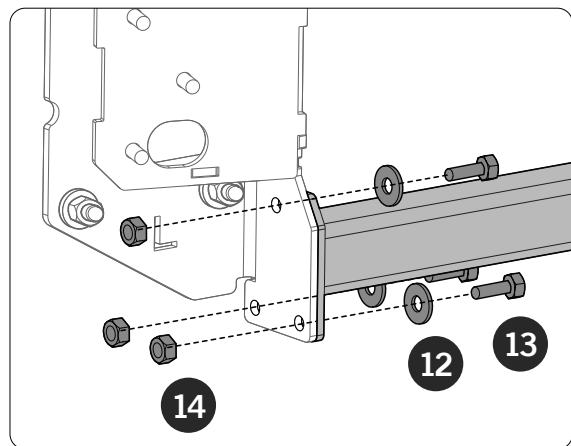
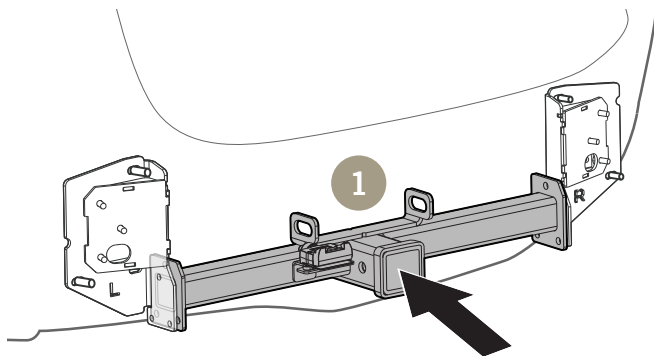

STEP 08

Centre the towbar on side bracket slots, then torque fully.

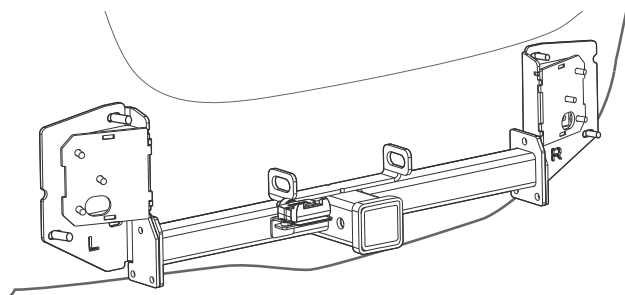

TIGHTEN ALL HARDWARE



M10: 60-70 NM

19mm Socket Wrench
17mm Socket Wrench
+ Torque Wrench

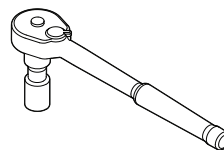

STEP 09

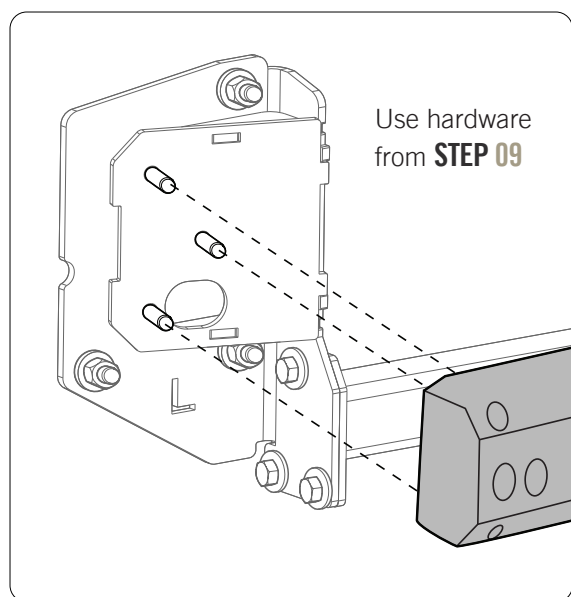
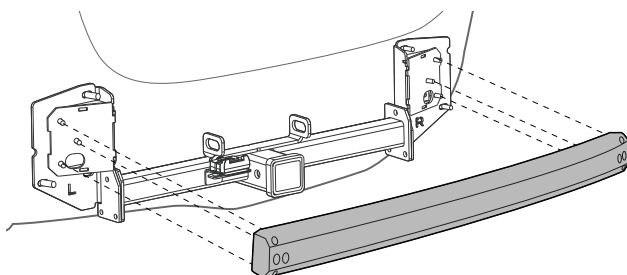

STEP 10

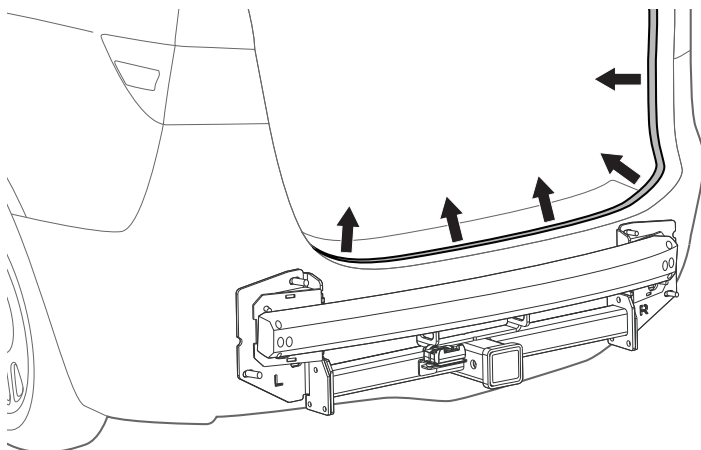

Carefully lift off rubber lining.

STEP 11

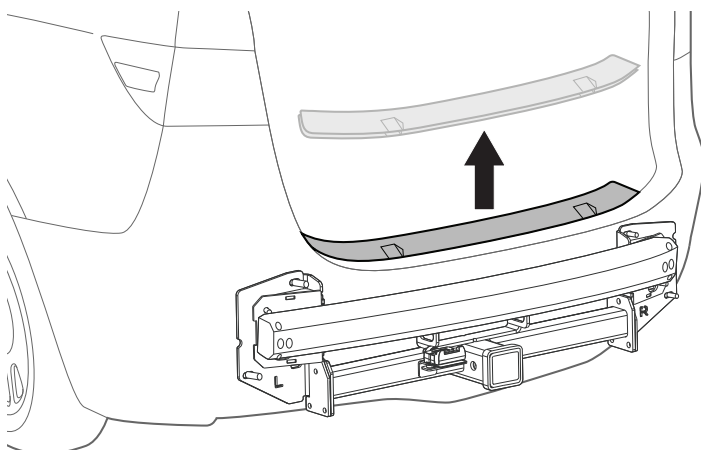

Carefully lift off boot plastic panel.

STEP 12

Carefully lift boot side panels towards the centre of the vehicle.

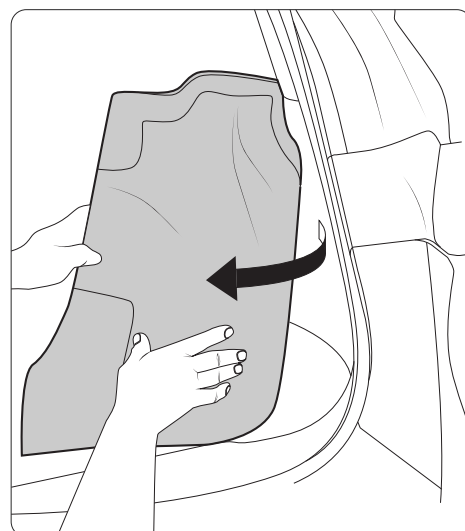
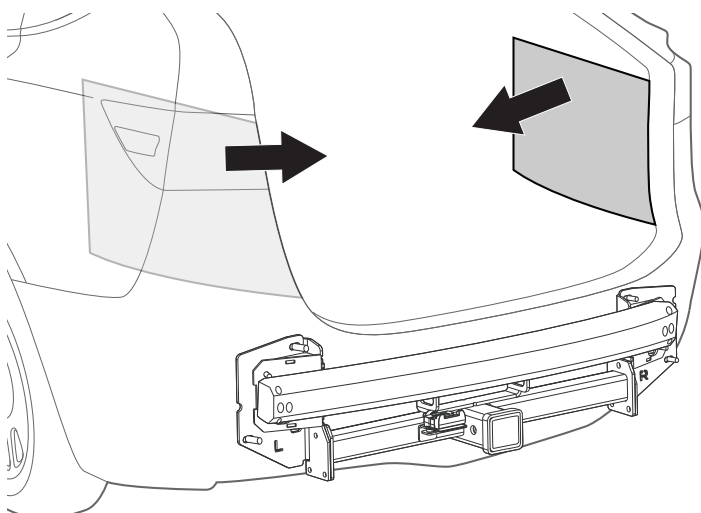

WIRING STEPS

STEP 13

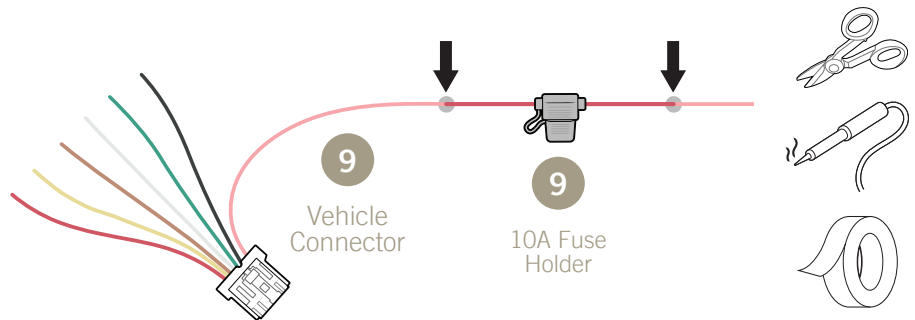

STEP 14

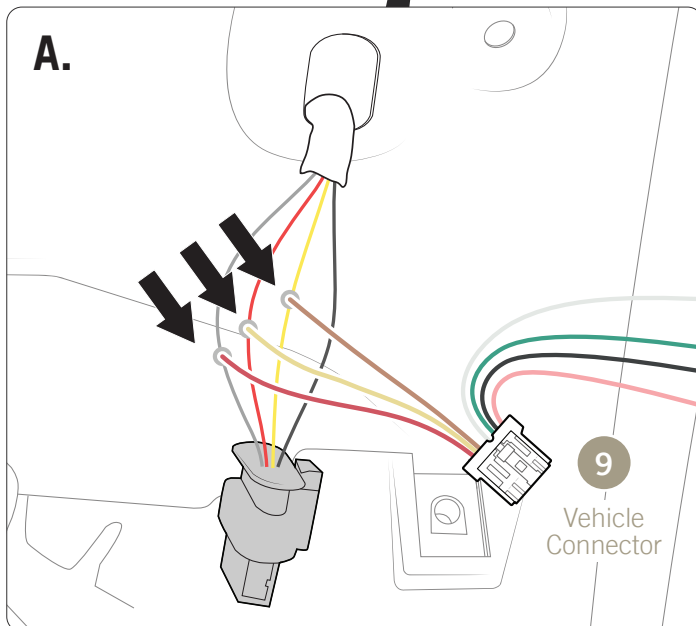
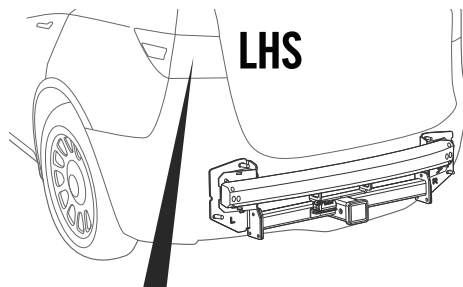

IMPORTANT: ALWAYS TEST LIGHTS TO CHECK FUNCTIONALITY. SOME VEHICLE WIRES MAY VARY IN COLOUR / APPEARANCE.

Connect ECU wires to Vehicle wires as follows:

| ECU | Vehicle |
|--------|------------------------|
| RED | > GREY (Brake light) |
| YELLOW | > RED (Left Indicator) |
| BROWN | > YELLOW (Tail Light) |



each individual connection

B. Solder the Pink ECU wire to the cigarette socket wire located behind the left hand boot panel.

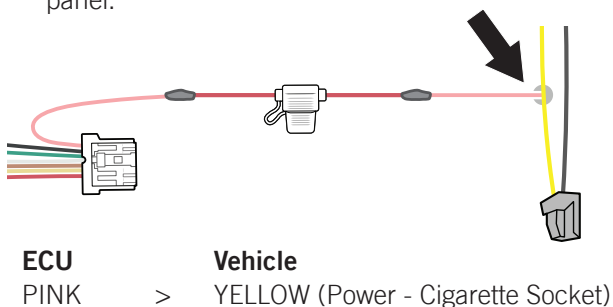

C. The white earthing is connected to earthing point next to cigarette socket.

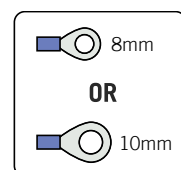

ECU WHITE > Vehicle EARTHING POINT

STEP 15

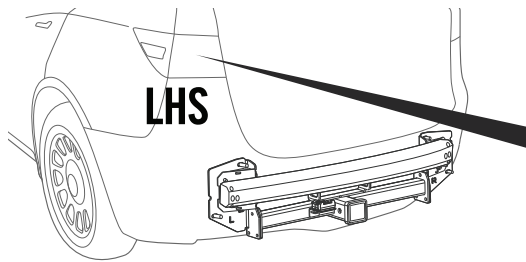

Solder 3 metres of Extension wire to **Green** ECU wire.

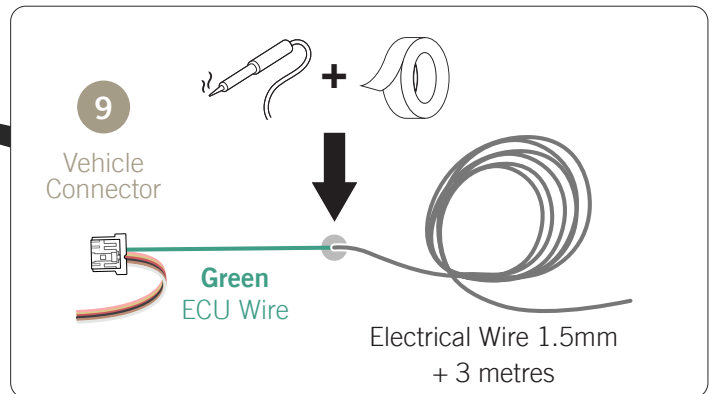

STEP 16

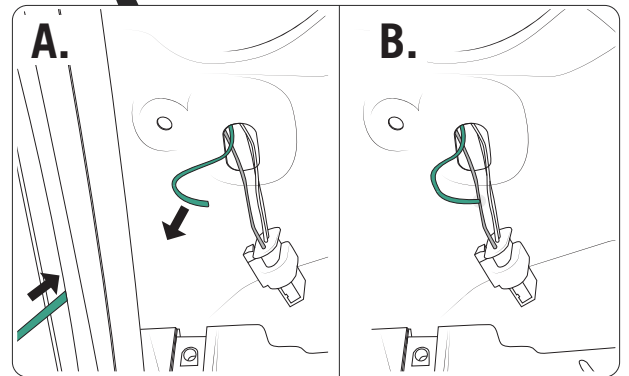
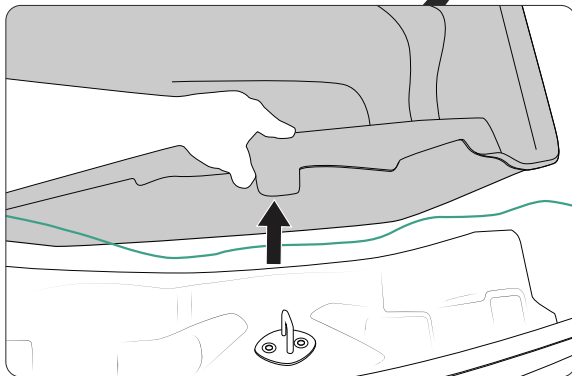
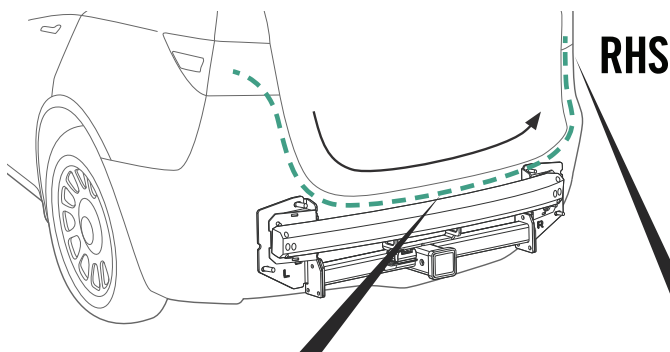

STEP 17

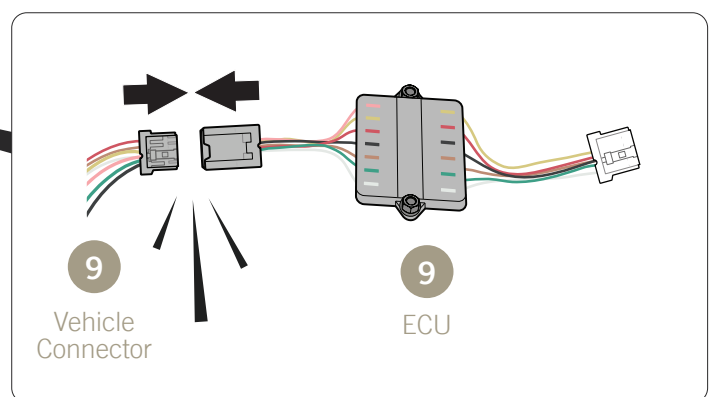
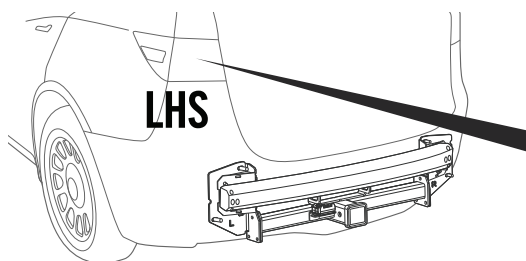

STEP 18

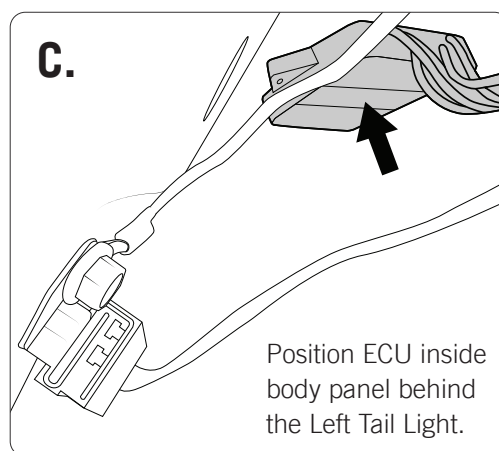
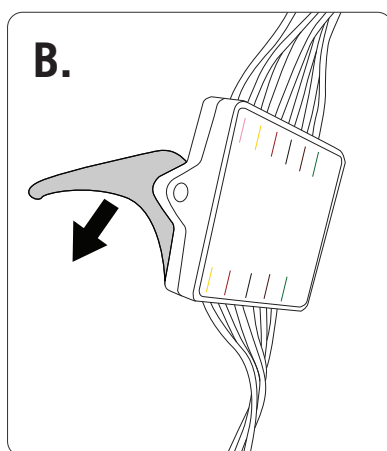
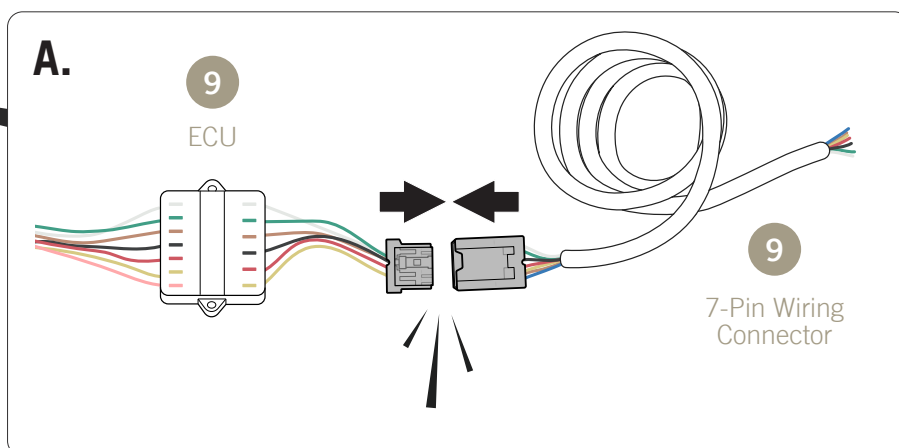
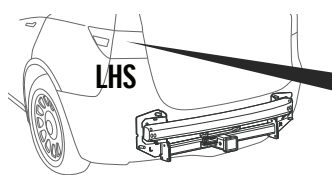

STEP 19

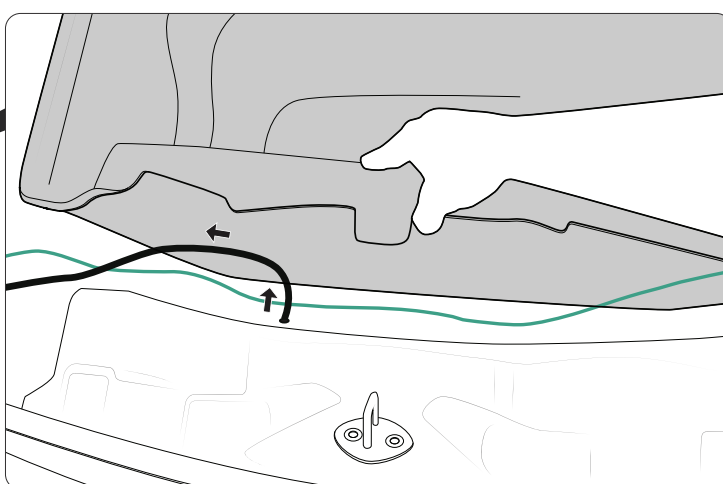
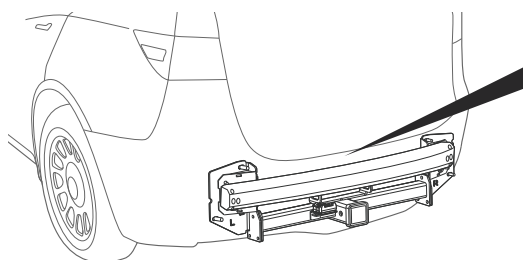

STEP 20

9
7-Pin Housing

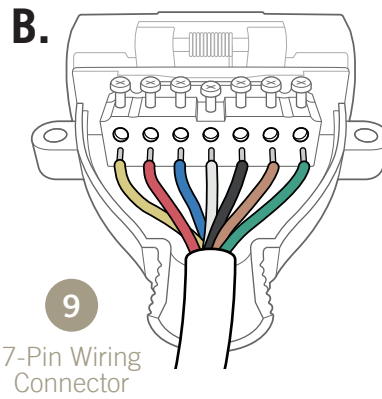
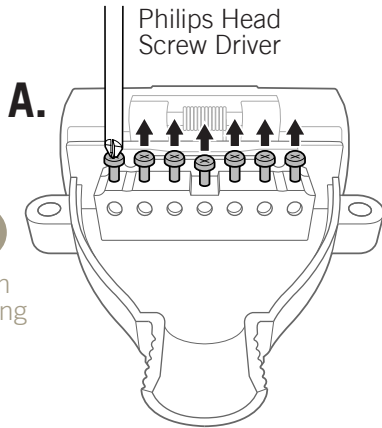

| | | | | | | |
|--------------------|-------------|---------------------|---------------|-------------------|--------------|-------------------|
| ⊗ | ⊗ | ⊗ | ⊗ | ⊗ | ⊗ | ⊗ |
| L. SIGNAL (Yellow) | BRAKE (Red) | ELECT. BRAKE (Blue) | EARTH (White) | AUXILIARY (Black) | TAIL (Brown) | R. SIGNAL (Green) |

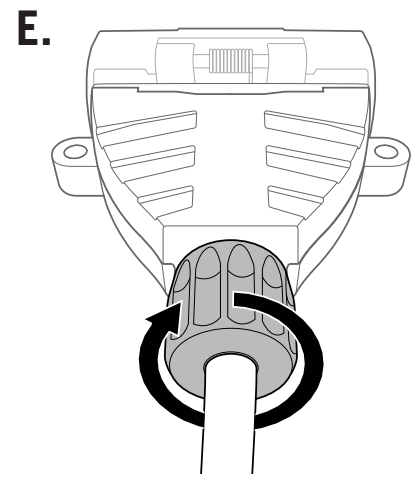
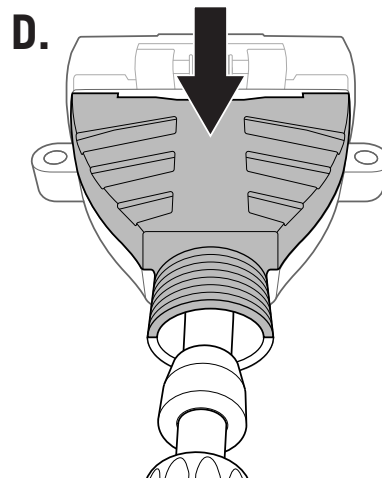
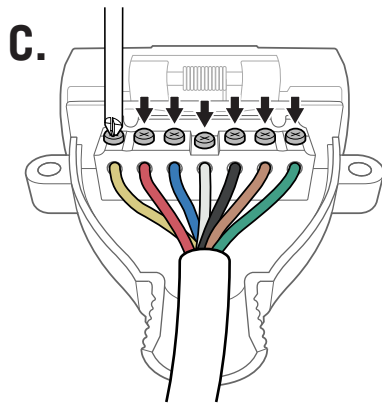

STEP 21

Install 7-Pin plug using M4 hardware. 19 20 21

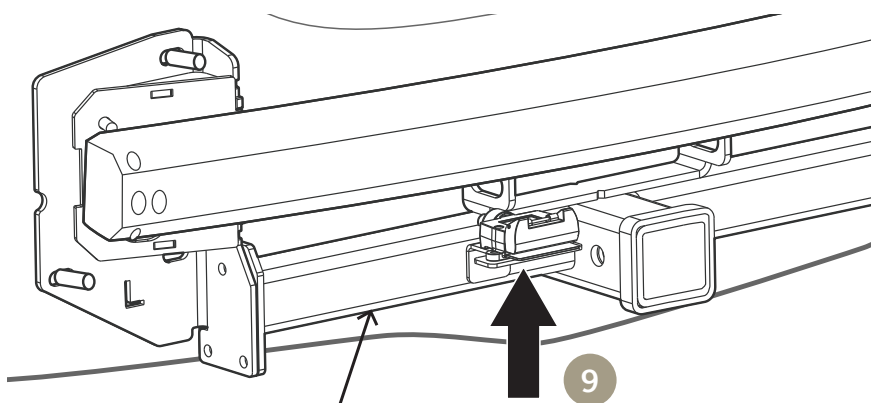

IMPORTANT: Zip-tie excess wire to the towbar / vehicle body.
Avoid sharp edges and areas with heat.

FINALISE FITMENT

STEP 22

COMPLETE STEPS **01-03** AND **10-12** IN REVERSE ORDER.

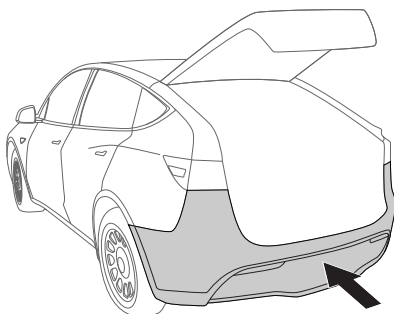

OPTIONAL HANDLE

STEP 23

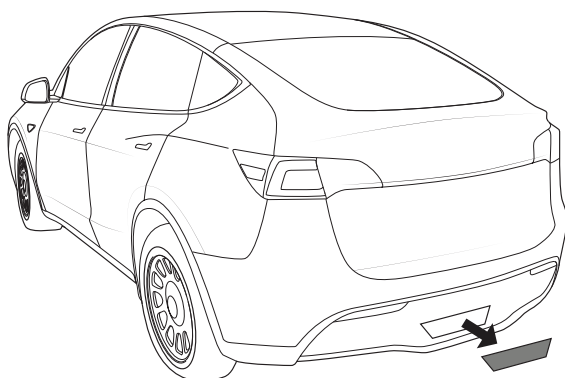

Remove the 11 tabs in housing from around the outside of the panel. Leave the 4 hooks in place.

Do not remove the hooks that are without housings.

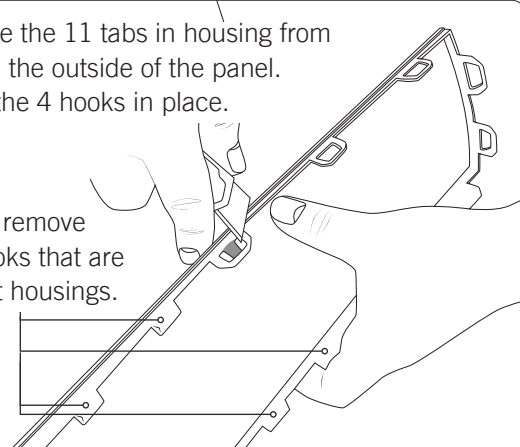

STEP 24

Locate the centre of the panel. Move in three squares from the top of the panel. Place the plate in position here.

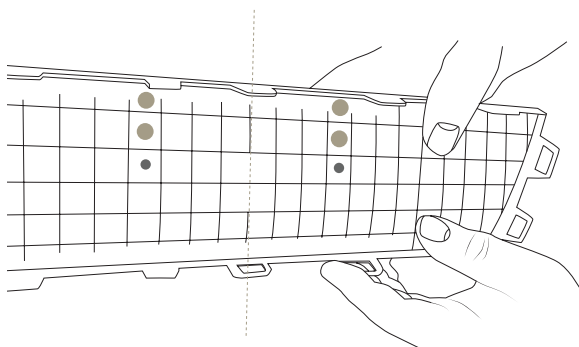

With the plate in this position, create a reference mark on the panel using the plate as a guide.

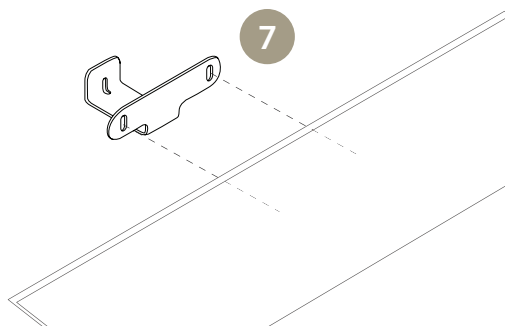



STEP 25

Drill marked holes. Install the handle to the plastic panel.

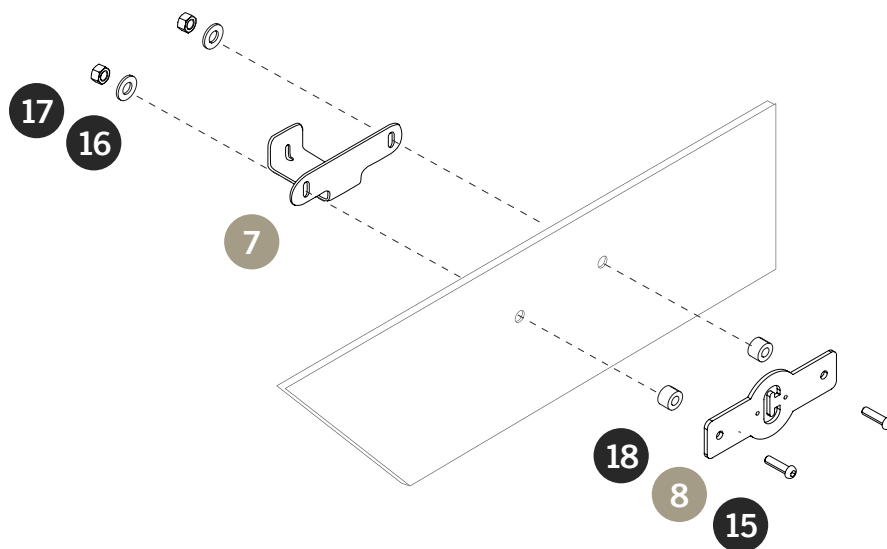

STEP 26

The panel can be reinstalled at this stage to cover the towbar.

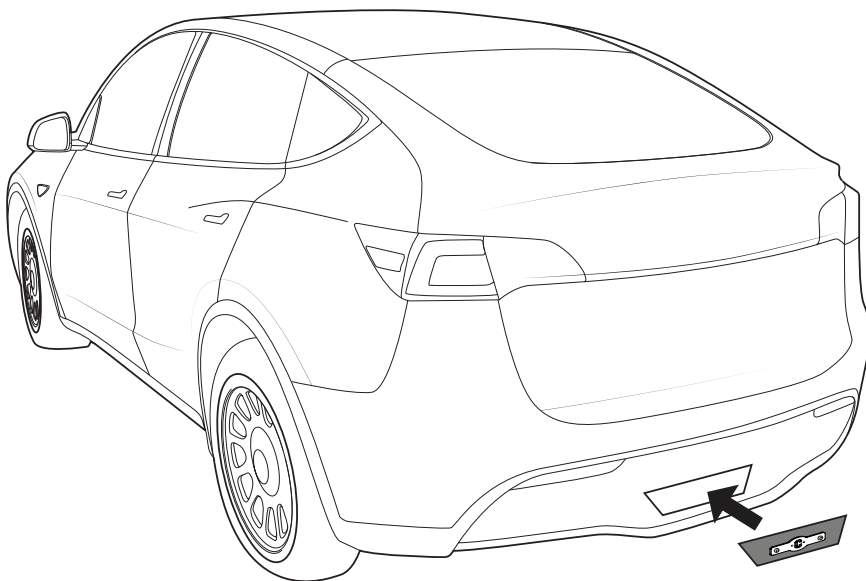

TOWBALL USAGE

STEP 27

EXAMPLE ONLY:

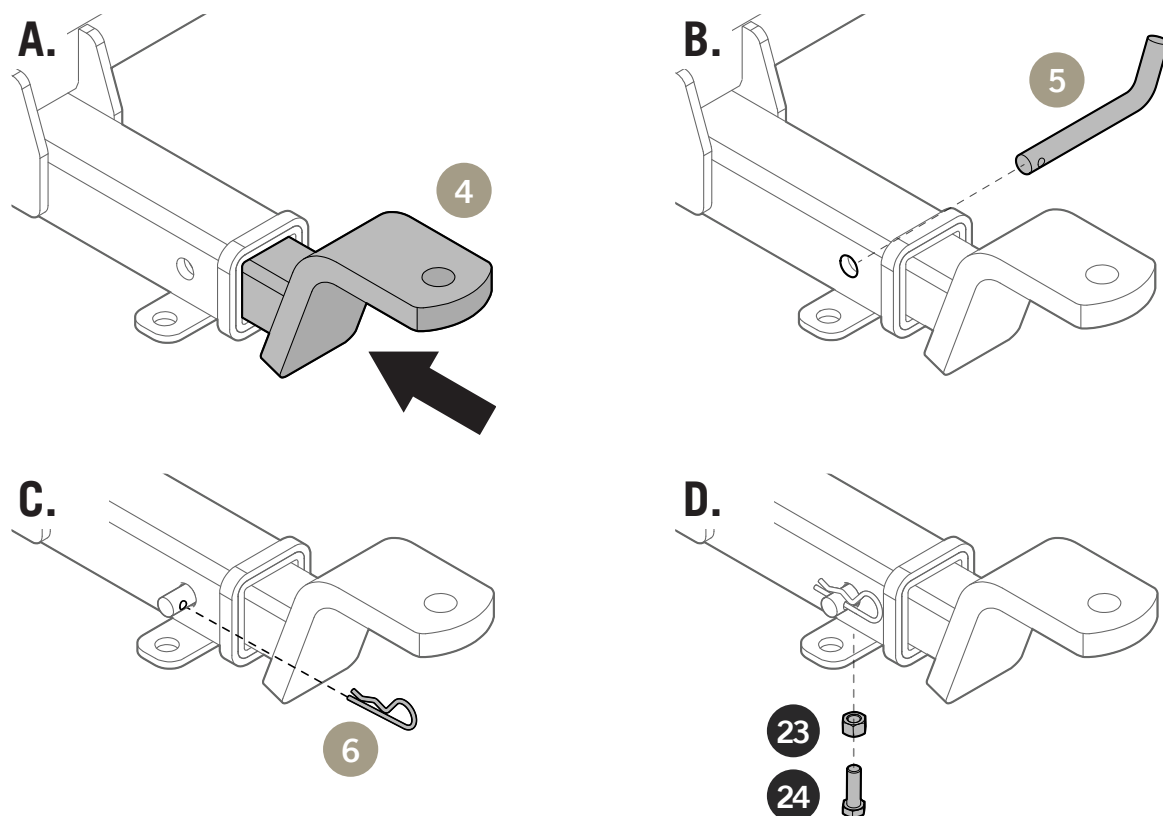

STEP 28

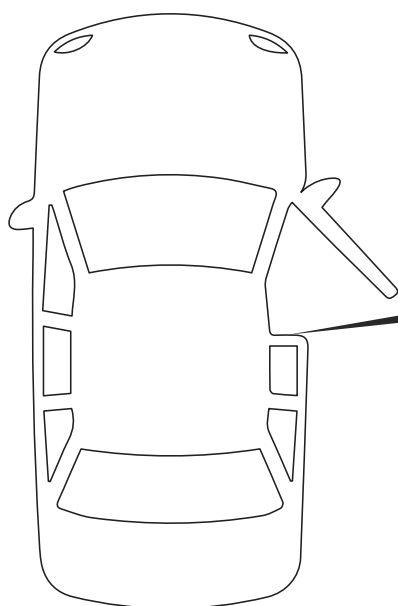

Place load rating sticker inside the driver's door.

